

NOTE:
 BOTTOM LAYER OF INSULATION SHALL BE LAID DOWN IN
 A STAGGERED PROFILE. STAGGER AND OFFSET TOP LAYER
 OF INSULATION FROM BOTTOM LAYER TO PREVENT
 ALIGNED EDGES.

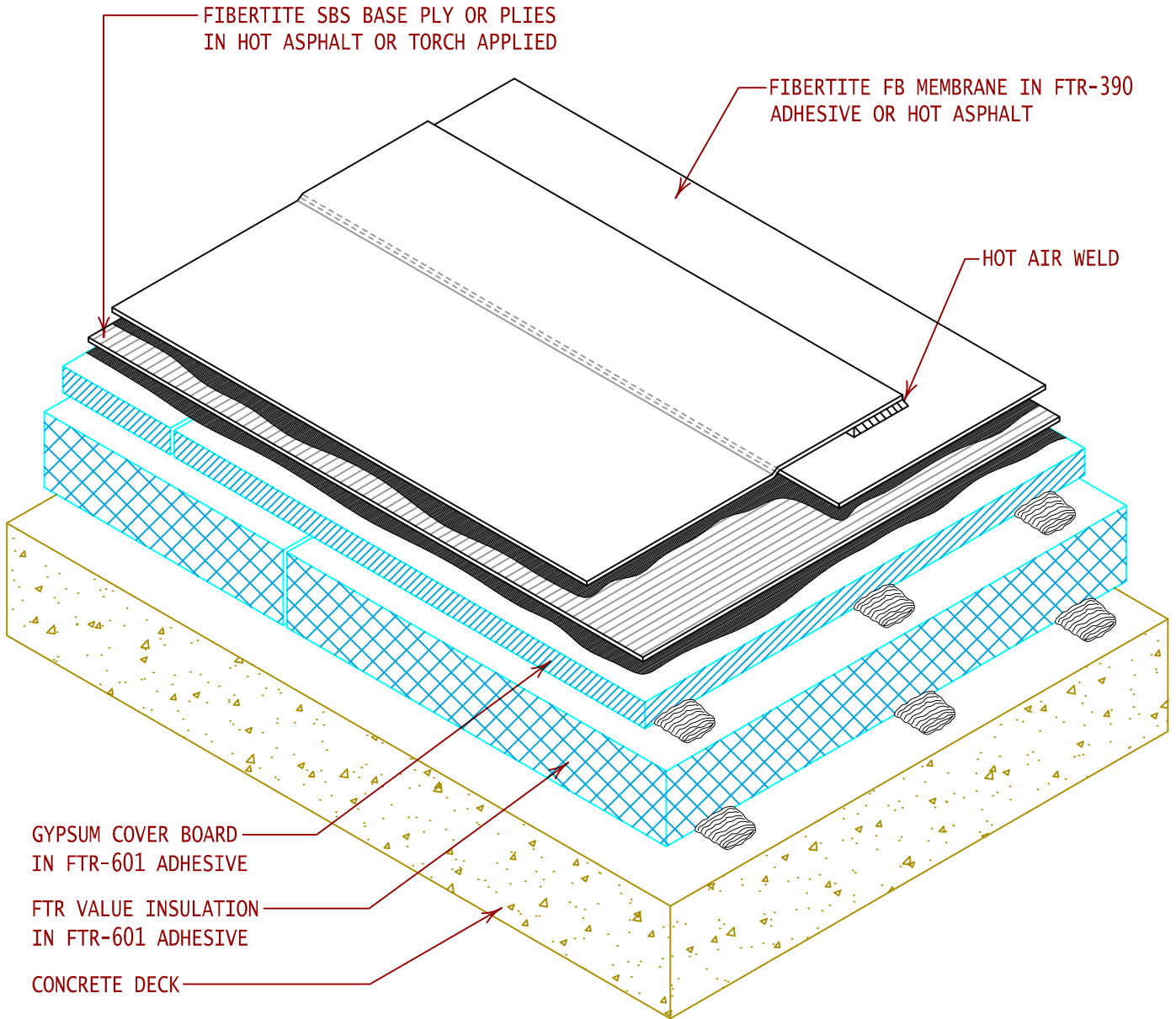

GENERAL REFERENCE:
 "FTR GS 02/13"
 APPLICABLE SYSTEMS:
 "FTR MP 02/13"

MULTI-PLY ROOF SYSTEM CROSS SECTION
 (ADHERED INSULATION IN FTR-601 ADHESIVE)

REVISES DETAIL	ISSUE DATE	DRAWING NUMBER
ALL PREVIOUS	08-13-13	FTR-DAS3MP