

NOTE:
INSULATION SHALL BE LAID DOWN IN
A STAGGERED PROFILE.

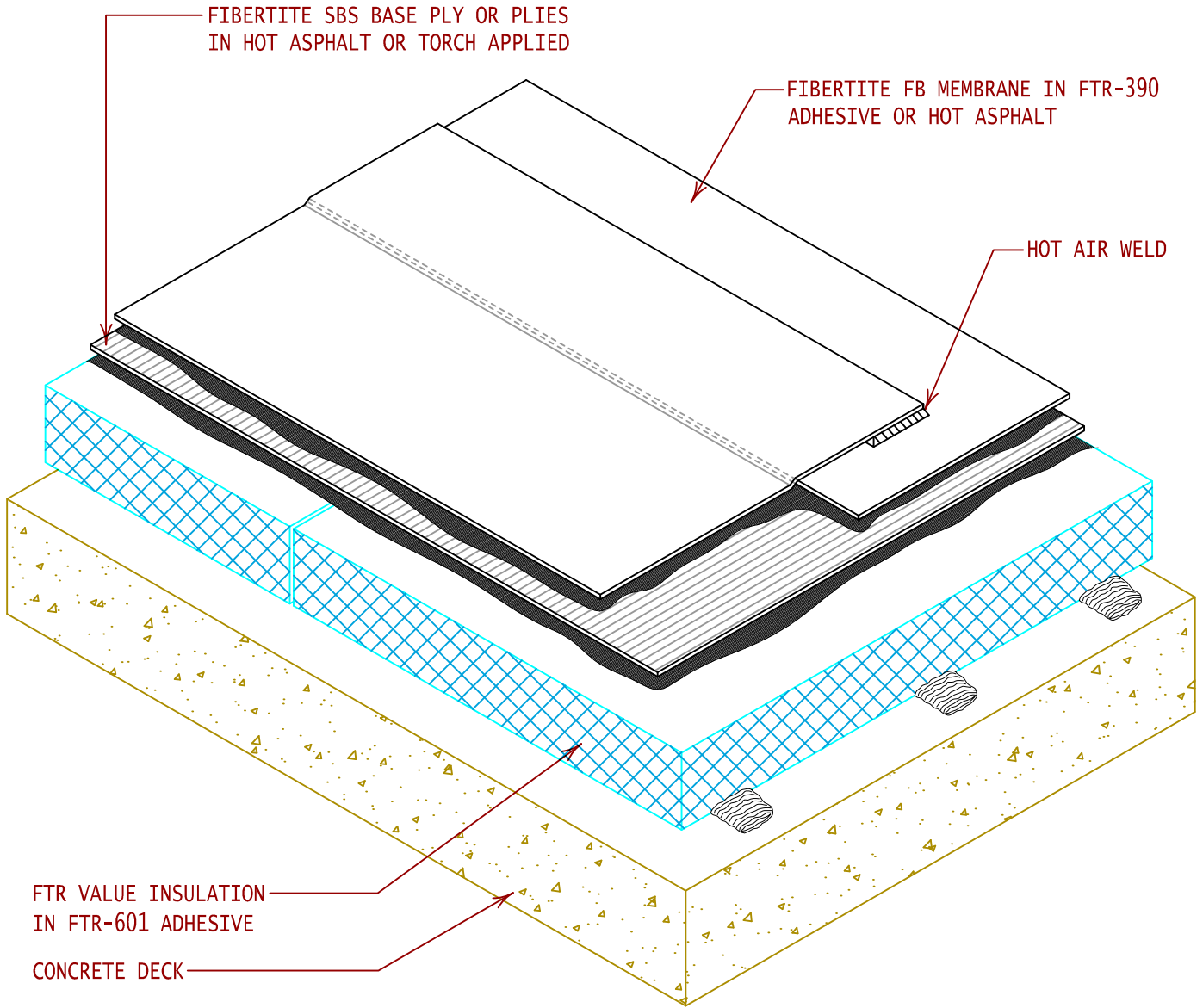

GENERAL REFERENCE:
"FTR GS 02/13"
APPLICABLE SYSTEMS:
"FTR MP 02/13"

MULTI-PLY ROOF SYSTEM CROSS SECTION
(ADHERED INSULATION IN FTR-601 ADHESIVE)

REVISES DETAIL	ISSUE DATE	DRAWING NUMBER
ALL PREVIOUS	08-13-13	FTR-DAS7MP