

# HyShed



## The industry's highest-rated total sanitary washdown enclosure solution.

Protect your critical electrical equipment with HyShed, the state-of-the-art sanitary washdown enclosure solution. HyShed is specially designed to withstand high pressure, high temperature washdown cleaning procedures in Food & Beverage applications.

Only HyShed gives you the ultimate power to quickly and more easily preserve the integrity of your sanitary conditions and equipment, while promoting lean processes.

### Ultimate Protection

#### STREAMLINED HYGIENIC DESIGN

- 1 Internally mounted hinges reduce catch points and corrosion
- 2 Crevice-free latch and screw surfaces use standard tool
- 3 Solid back with no pre-tapped holes for easy weld mounting
- 4 Sloped top
  - Prevents fluids or particulates from pooling
  - Degree of slope maximizes back panel space and minimizes footprint
- 5 Replaceable blue FDA-grade silicone gasket
  - Easy to replace, clean, maintain and install
  - Resists bacteria growth and chemical absorption
  - Helps eliminate the possibility of water entry
- 6 Complete 304 stainless steel construction and hardware
  - No. 4 Dairy finish better protects against corrosion, moisture entry and collection of particulates

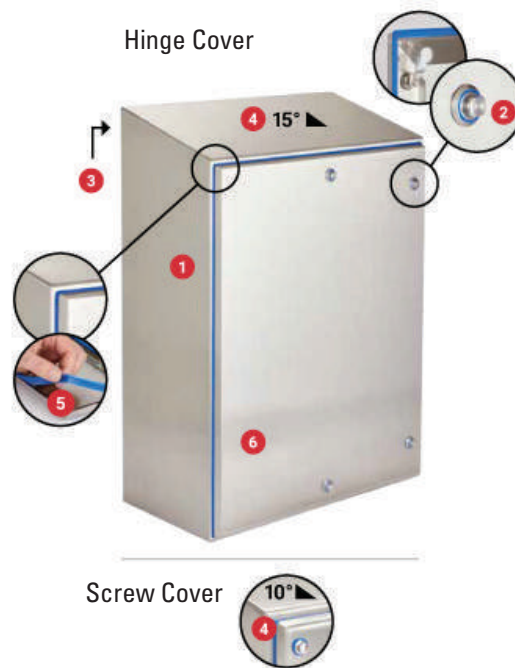

Full enclosure and accessory solution

- 8 hinge cover models
- 5 screw cover models
- Variety of new IP69K-rated accessories



**Pepco**  
Professional Electric  
Products Company

**2019  
MAY  
EDITION**

## Featured Products

Sponsored By:

**nvent**  
**HOFFMAN**

Contact your Pepco  
Sales Rep for more  
information about  
Hoffman products.

*"From Substation to Workstation...  
We're Distribution Unleashed!"*

[www.pepconet.com](http://www.pepconet.com)

1.800.872.7000