



# Setting the Standard for Seal-less Pumps

Looking for a greener, more economical pump?

The SLP Series is the first seal-less rotary displacement pump not based on a magnetic drive.

This ATEX-certified pump reduces absorbed power up to 30 percent and increases efficiency 20 percent compared to magnetic drives.

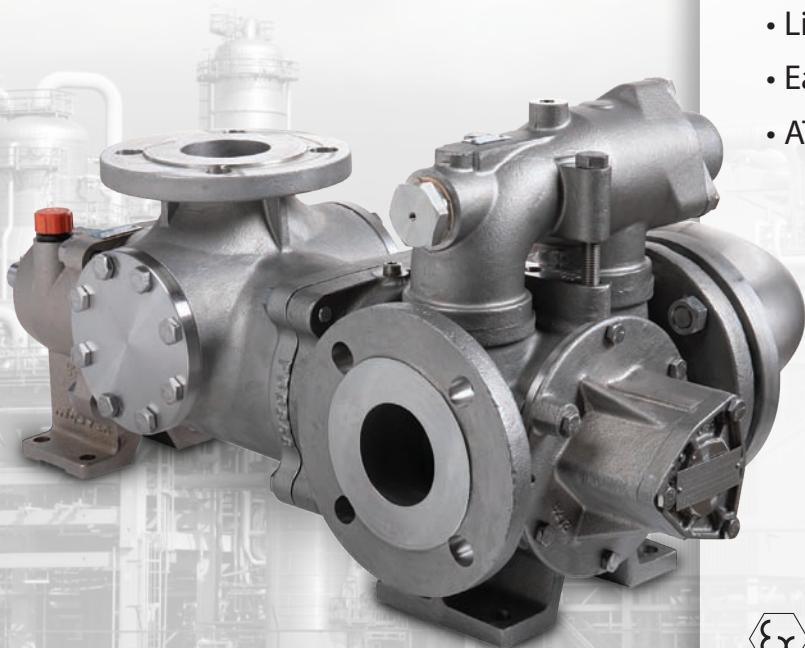

## Mouvex® SLP Series Rotary Vane Pumps

The Mouvex SLP 25 i pump — the energy-efficient technology for chemical applications.

### Features & Benefits:

- Seal-less, leak-free
  - No magnets
  - No mechanical seals
  - No packing
- All stainless steel construction
- Reduced energy consumption
- Constant high performance over time
- Ideal for thin or non-lubricating, viscous and corrosive fluids
- Excellent volumetric characteristics
- Self priming
- Dry-run capable
- Line stripping capabilities
- Easy, reduced maintenance
- ATEX certified



Where Innovation Flows





# SLP 25 i Series Vane Pumps

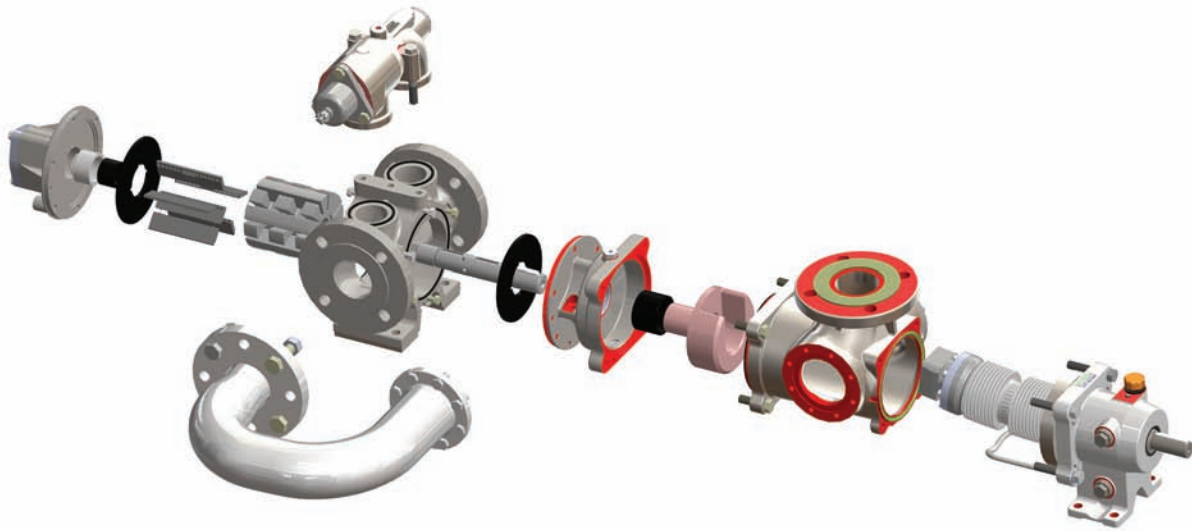

- All stainless steel construction
- Shaft sealed by double stainless steel bellows
- Easy, Reduced Maintenance
- Highly efficient sliding vane technology
- Self-adjusting vanes sustain performance
- FEP Static Sealing
- ATEX Certified

## Applications:

- Acids
- Caustics
- Solvents
- Chemicals

## Operating Limits

Pump Model	Maximum Pump Speed	Maximum Flow Rate		Maximum Differential Pressure		Maximum Temperature		Maximum Viscosity	
	rpm	m <sup>3</sup> /hr	gpm	bar	psi	°C	°F	cSt	ssu
SLP 25 i	1,000	25	110	12	175	100°	212°	60,000	275,000

## Vane Pump Principle

Vane pumps have a number of vanes that are free to slide into or out of slots in the pump rotor. When the pump driver turns the rotor, centrifugal force, rods and/or pressurized fluid causes the vanes to move outward in their slots and bear against the inner bore of the pump casing forming pumping chambers. As the rotor revolves, fluid flows into the area between the vanes (pumping chambers) when they pass the suction port. The fluid is transported around the pump casing until the discharge port is reached. At this point, the fluid is squeezed out into the discharge piping.

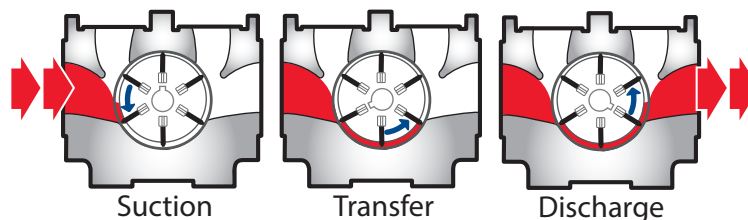

ZI la Plaine des Isles • 2 rue des Caillottes  
 F-89000 AUXERRE - FRANCE  
 Tel: + 33.3.86.49.86.30 • Fax: + 33.3.86.46.42.10  
 contact@mouvex.com  
[mouvex.com](http://mouvex.com)

Authorized PSG® Partner: