



## WEBBING REPLACEMENT PROCEDURE

*for QUICKFLIGHT devices*

A new hex head shackle pin is included with pre-applied locking compound in every replacement webbing kit. Use this pin when changing the webbing. Refer to the instructions below:

1. Place the device on a sturdy workstation taking care not to damage the plastic side covers - Ensure it is secure and cannot fall.
2. Pull out the Nozzle Pin.
3. Pull approximately 2 feet of each upper webbing from the unit and hold them to prevent retraction.
4. Lift out the three sections of the Nozzle.

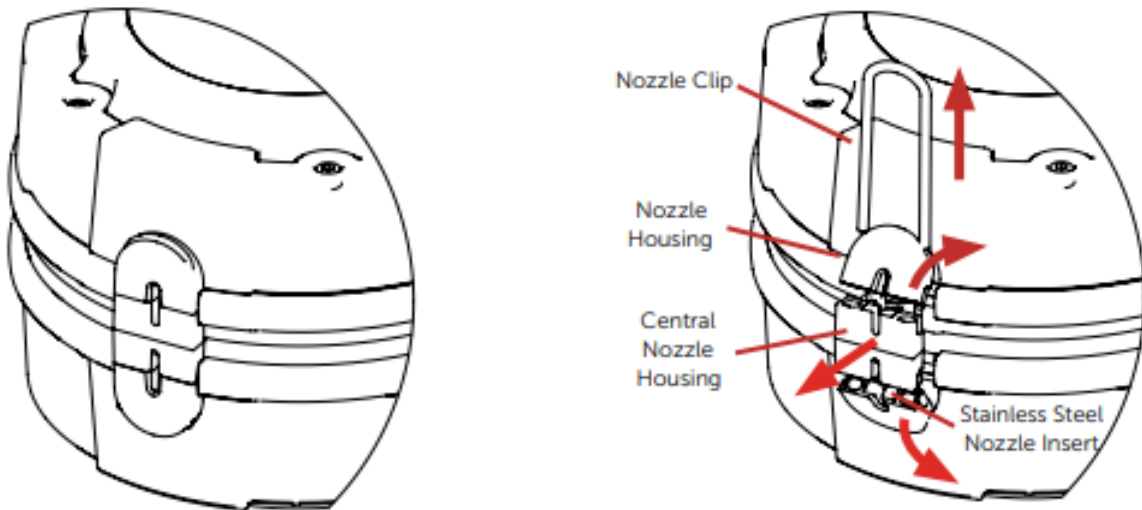

*Note: Webbing line not shown*



### USE ONLY GENUINE TRUBLUE REPLACEMENT PARTS

5. While holding the device securely, pull out both the remaining webbing lines and the end of the drum leads and the joining shackles are exposed.
6. Locate the loop in the drum leads, approx. 150 mm (6 in) past the link - Place a suitable pin through both of the drum leads to prevent them from retracting back inside the casing.



### DO NOT ALLOW DRUM LEADS TO RETRACT INTO HOUSING

IF EITHER DRUM LEAD RETRACTS BACK INTO THE DEVICE, THE DEVICE WILL REQUIRE SERVICE BY AN AUTHORIZED SERVICE CENTER.

Head Rush Technologies  
1835 38th Street, Boulder, CO 80301

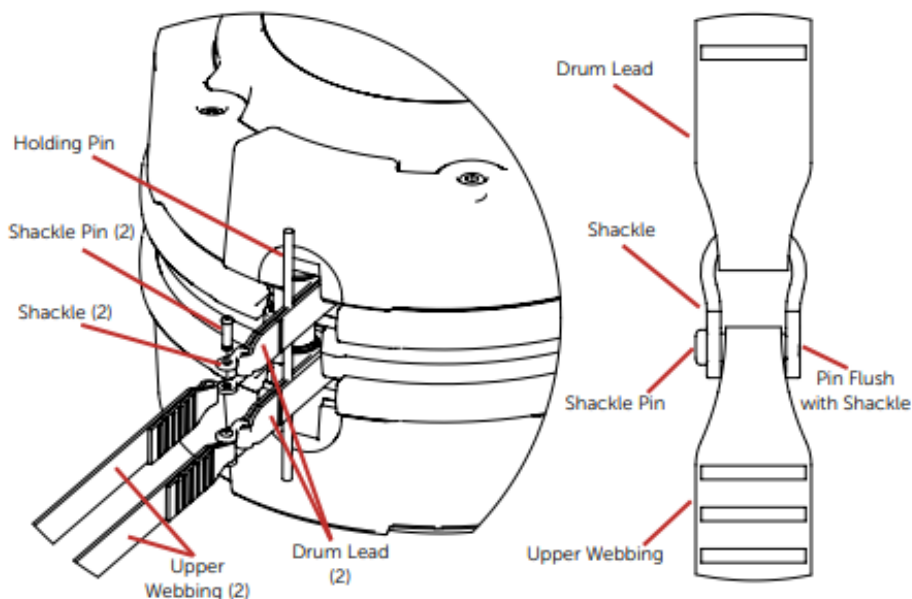

*Webbing joining link parts*

7. Unscrew the shackle pin of webbing being replaced using the provided 2.5mm hex wrench. Discard this pin.
8. Remove old webbing line. Do not remove the shackle from the drum lead. Ensure the loop part of the shackle is fitted to the drum lead.



**THREAD LOCKING COMPOUND**

Ensure the factory applied thread locking compound is present on the shackle pin threads. Do not reuse the old shackle pin.

9. Fit the new line, passing the provided threaded shackle pin through the loop as shown.
10. Tighten the shackle pin to 2 Nm(18 lb-in), ensuring the threads are fully engaged and the end of the pin is flush with the joining shackle as shown.

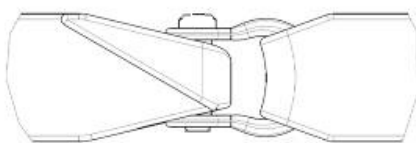

*Correct shackle fit*

11. Remove the holding pin and allow both lines to slowly retract until drum lead and joining link is inside casing.
12. Refit nozzle assembly - Refer to steps 2-4 in the reverse order.
13. Slowly retract the webbing lines into the casing, checking the action is smooth and adequate spring resistance is felt.
14. Once the lines are fully retracted, pull out both lines a short distance (1m) using reasonable force and allow them to retract. Repeat two or three times to ensure lines are firmly wound onto the drum.
15. Return the device to service and check for correction operation.