



Facility Guide

calgary TELUS convention
centre
be part of the energy™

FOR INNOVATIVE MEETINGS...

THE colab

Colab

Collaboration is the cornerstone. We've designed the Colab space to encourage groups to meet differently. From strategy sessions to intensive collaborative work, take advantage of our unique space to create new ideas.

TELUS Rooms, North Side,
Main Level



South Side,
Main Level



Ideation Centre

Ideation Centre

Four unique rooms create a space far from the main hustle and bustle of larger events, allowing you and your team to focus in smaller groups. The modern furnishings and bright space are complemented with our attentive service, making your next group session truly engaging.

... AT THE CENTRE.

Upper Select Boardroom

A modern and executive-style setting, the Upper Select Boardroom has been designed with the corner office in mind. Featuring current teleconferencing facilities, bring your team together from around the world to engage in your biggest corporate challenges.

UPPER **SELECT** BOARDROOM



Glen Rooms, South Side,
Upper Level



TELUS Rooms, North Side,
Main Level

Main Level Boardroom

A private and modern retreat in the heart of downtown Calgary, the Main Level Boardroom has been designed to foster productive small team meetings. From corporate presentations to strategy sessions, your team can get away from the usual boardroom setup to move big ideas forward.

MAIN LEVEL BOARDROOM

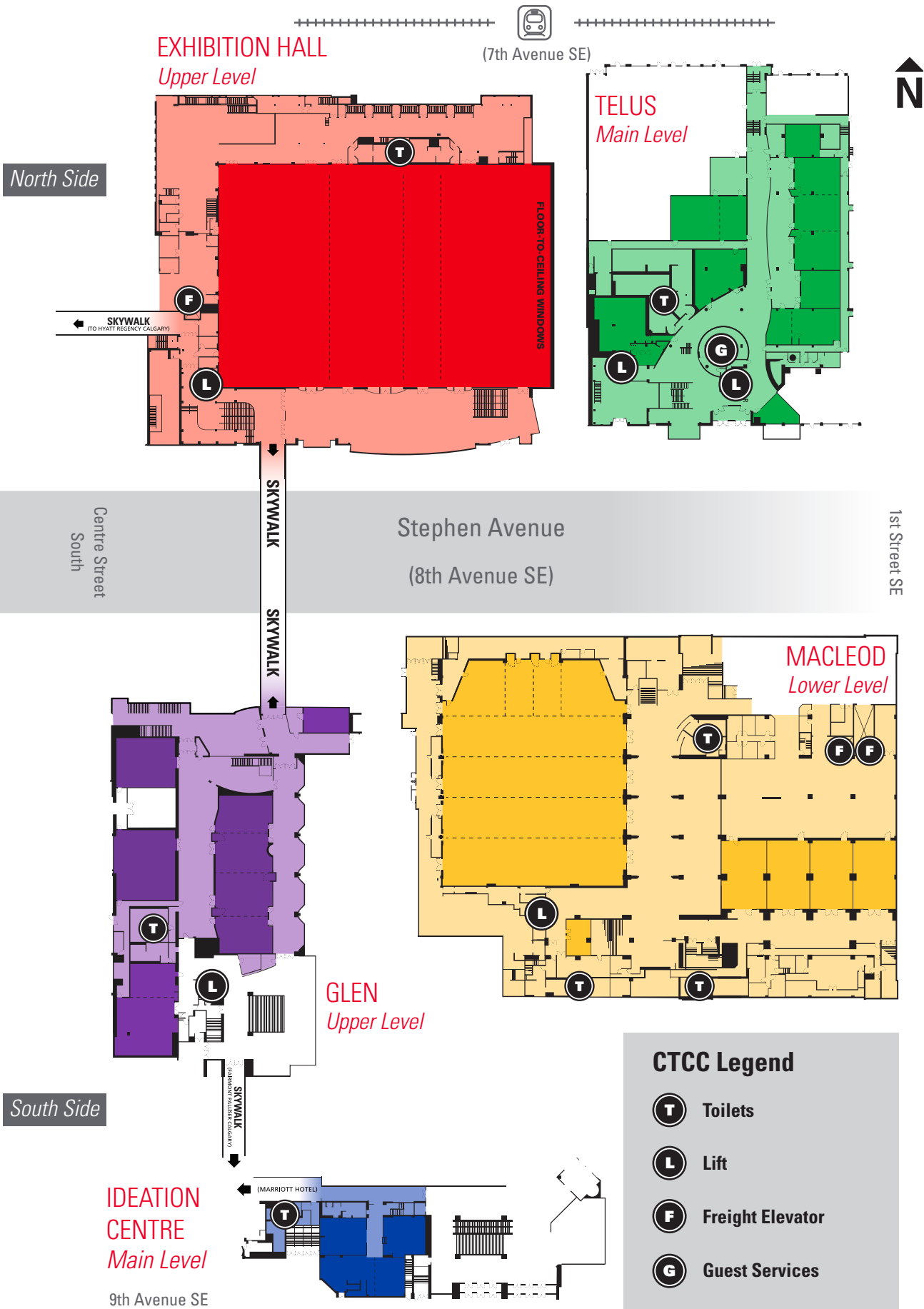

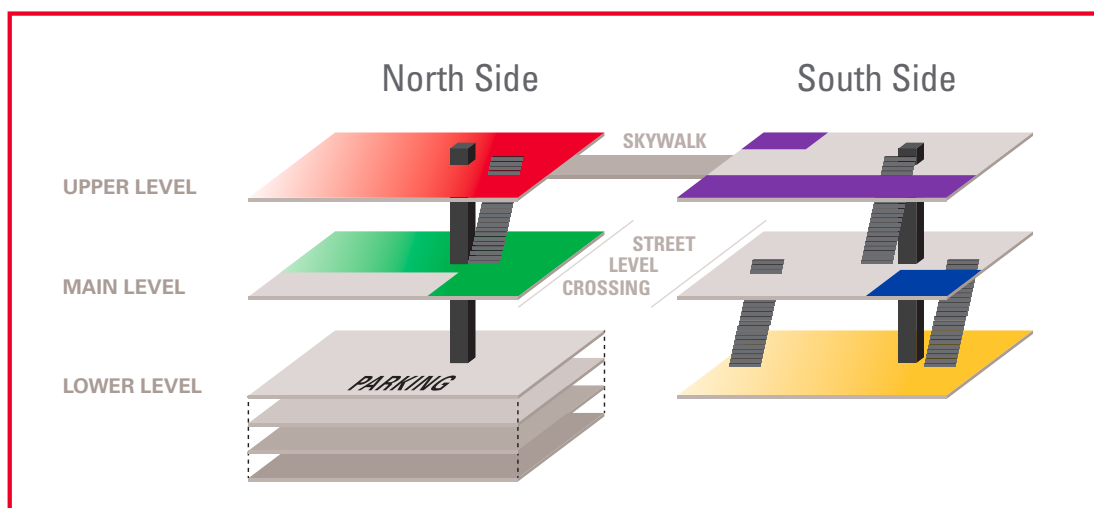

Located across three levels in two inter-connected buildings, Calgary TELUS Convention Centre combines flexible spaces with our attentive service to provide a truly memorable experience for you and your attendees and guests.



Calgary TELUS Convention Centre is located at the centre of Calgary's downtown core, a short walk to more than 4,000 three- and four-star hotel rooms. For your convenience, you can even take advantage of Calgary's +15 Elevated Skywalk for direct access to 1100 of those rooms, including those at Calgary Marriott Downtown Hotel, Hyatt Regency Calgary and Fairmont Palliser Calgary.

EXHIBITION HALL

- Our largest space for your grandest event
- Floor-to-ceiling windows provide ample natural lighting and inspiring views
- Can be partitioned into three separate halls

Exhibition Hall CDE offers 4,370 square meters of pillarless space, which can be divided into three multi-purpose halls. This space has hosted keynote speakers of international acclaim: prime ministers, royalty, former U.S. presidents and renowned minds. It has also hosted hundreds of tradeshows, consumer events, galas and award ceremonies.

The spacious and elegant pre-function area can be used for display space, informal gatherings and registration as well as for receptions and refreshment breaks. The pre-function area's floor-to-ceiling east- and south-facing windows provide inspiring views.

ROOM	CAPACITIES (MAXIMUM)			Meals*	Reception	Theatre Style	Class Room	Booth 3 × 3
	METERS	m ²	CEILING					
North Building								
Hall CDE	54.0 × 80.9	4,370.8	9.1	3,600	3,642	4,000	2,700	253
Hall C	54.0 × 27.2	1,471.7	9.1	1,080	1,240	1,300	900	86
Hall D	54.0 × 18.1	976.2	9.1	720	855	850	600	61
Hall E	54.0 × 26.7	1,443.8	9.1	900	923	1,300	900	90
Hall CD	54.0 × 45.3	2,448.0	9.1	1,980	2,108	2,200	1,600	141
Hall CDX	54.0 × 54.2	2,927.0	9.1	2,340	2,507	2,600	1,800	169
Hall DX	54.0 × 26.9	1,455.3	9.1	1,080	1,268	1,300	900	89
Hall DXE	54.0 × 53.7	2,899.0	9.1	2,160	2,190	2,600	1,800	173
Hall XE	54.0 × 35.6	1,922.8	9.1	1,260	1,323	1,750	1,200	118
Pre-Function	58.9 × 13.1	773.2	6.7	350	786	-	-	20
North Building Show Offices								
Show Office 1	3.8 × 7.1	27.3	2.4					
Show Office 2	4.5 × 3.4	15.5	2.4					
Show Office 3	4.5 × 2.4	11.0	2.4					
Green Room	7.3 × 6.1	44.0	2.1					

Note: Capacity numbers will decrease with the addition of audio visual equipment, head tables, staging, etc.

*Meals are based on rounds of 12.



NORTH SIDE

Upper Level

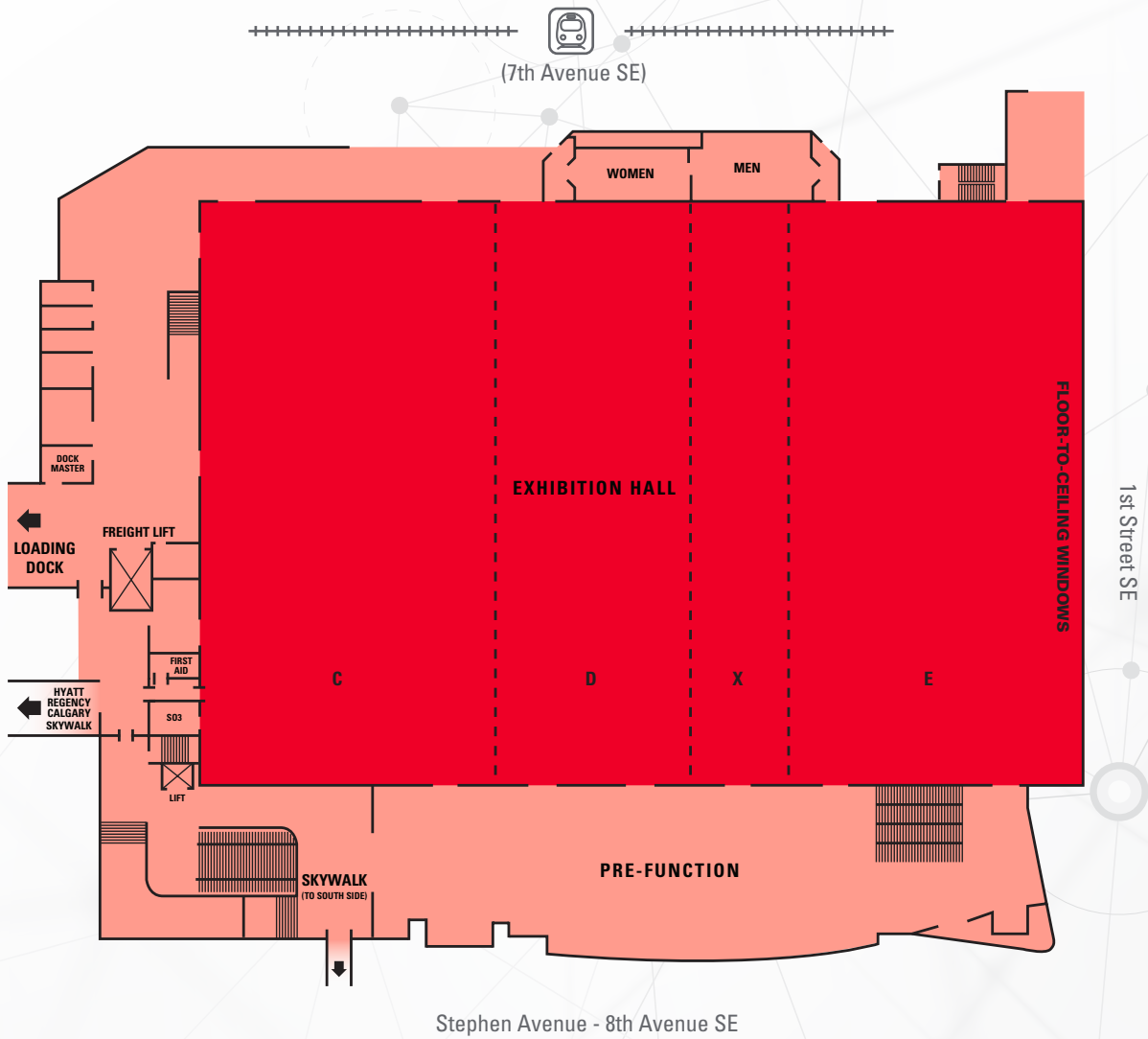

EXHIBITION HALL



Movable walls are indicated by dashed lines.

TELUS

- Highly flexible for gatherings of all sizes
- Guest Services provides business services to attendees requiring last minute assistance
- Home to Colab and Main Level Boardroom

The TELUS Rooms provide the ultimate in flexibility for a meeting or conference. Ideal for concurrent session planning, they have flexible room configurations and a spacious foyer.

Adjacent pre-function areas are glass-enclosed for privacy while keeping the space open and welcoming. Ideal for registration, refreshments or receptions.

ROOM	CAPACITIES (MAXIMUM)			Meals*	Reception	Theatre Style	Class Room	Board Room	Hollow Square	U-Shape
	METERS	m ²	CEILING							
North Building										
TELUS 101	8.4 × 5.0	41.6	3.1	30	43	35	24	18	22	20
TELUS 102	8.4 × 10.8	90.4	3.1	60	77	86	54	26	36	30
TELUS 103	9.1 × 8.7	80.0	3.0	50	66	72	45	26	30	24
TELUS 104	10.6 × 9.1	96.3	3.1	60	83	77	54	26	36	27
TELUS 105	10.6 × 8.4	88.6	3.1	60	74	91	54	26	36	27
TELUS 106	10.6 × 8.7	92.1	3.1	60	69	77	54	26	36	27
TELUS 107	7.6 × 7.9	60.4	2.2	40	47	50	30	18	26	22
TELUS 108	10.5 × 6.8	71.4	2.8	60	60	56	36	24	24	24
TELUS 109	9.3 × 8.4	77.9	2.8	50	57	72	36	26	30	24
TELUS 110 (Cloak Room)	8.9 × 12.0	107.5	3.0	80	114	85	60	34	36	30
TELUS 101–102	8.4 × 15.8	132.1	3.1	110	120	130	84	48	50	46
TELUS 104–105	10.6 × 17.4	184.9	3.1	130	157	175	90	50	52	44
TELUS 104–106	10.6 × 26.1	277.1	3.1	200	226	245	162	74	82	74
TELUS 105–106	10.6 × 17.0	180.7	3.1	130	143	168	90	50	52	44
TELUS 108–109	10.5 × 15.2	160.1	2.8	110	116	131	81	44	48	44
TELUS Pre-function (101–107)	6.4 × 35.5	226.4	3.3	-	189	-	-	-	-	-
TELUS Pre-function (108–109)	7.9 × 5.8	45.7	3.4	-	38	-	-	-	-	-
Colab	13.2 × 12.3	161.7	2.5	-	-	-	40	-	-	-
Main Level Boardroom	4.5 × 6.3	96	-	-	-	-	-	10	-	-

Note: Capacity numbers will decrease with the addition of audio visual equipment, head tables, staging, etc.

*Meals are based on rounds of 10.



North SIDE

Main Level

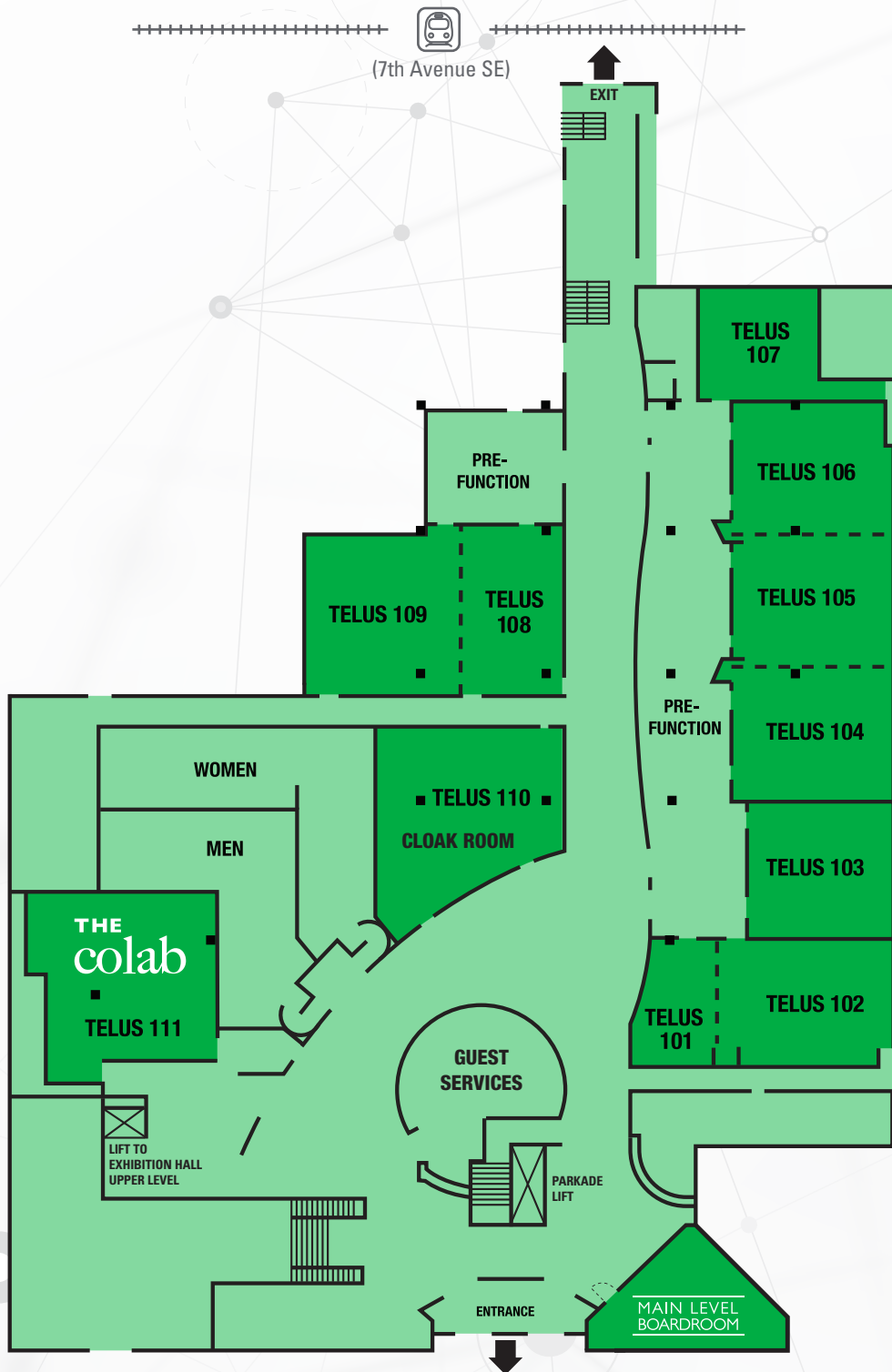

Stephen Avenue - 8th Avenue SE

Movable walls are indicated by dashed lines.

GLEN

- Eight individual rooms available
- Partition walls can be moved to create a customized space
- Private pre-function space available

The Glen Rooms offer flexible configurations and a large pre-function space spanning nearly the length of the section.

Bright, airy interiors give the Glen Meeting Rooms and pre-function space a warm, comfortable feel.

The Glen pre-function space is surrounded by a skylit area—ideal for registration, a pre-meeting breakfast or a lunch buffet.

ROOM	CAPACITIES (MAXIMUM)			Meals*	Reception	Theatre Style	Class Room	Board Room	Hollow Square	U-Shape
	METERS	m ²	CEILING							
South Building										
Glen 201	11.4 × 8.3	94.6	3.0	80	69	90	45	32	38	33
Glen 202	11.6 × 8.4	97.4	3.0	80	74	90	45	32	38	33
Glen 203	11.6 × 8.4	98.3	3.0	80	74	90	45	32	38	33
Glen 204	11.2 × 8.3	93.1	3.0	80	74	90	45	32	38	33
Glen 205	12.3 × 10.5	128.4	2.7	90	107	100	72	32	46	36
Glen 206	12.5 × 14.8	185.6	2.7	150	155	176	120	44	60	48
Glen 208	9.6 × 7.1	68.5	2.7	50	56	63	30	22	30	24
Glen 209	11.7 × 12.1	142.0	2.7	90	121	130	78	30	42	36
Glen 201–202	11.4 × 16.7	190.2	3.0	160	143	180	96	44	58	55
Glen 201–203	11.4 × 25.2	286.2	3.0	240	217	270	144	66	-	-
Glen 201–204	11.4 × 33.5	380.8	3.0	320	291	360	189	88	-	-
Glen 202–203	11.6 × 16.9	195.2	3.0	160	148	180	105	44	58	55
Glen 202–204	11.6 × 25.2	291.6	3.0	240	222	270	144	66	-	-
Glen 203–204	11.6 × 16.8	195.2	3.0	160	148	180	96	44	58	55
Glen 208–209	9.6 × 19.3	185.0	2.7	150	177	200	126	50	60	54
Glen Pre-function	7.6 × 38.1	290.3	2.3 - 7.7	-	242	-	-	-	-	-
Upper Select Boardroom	9.8 × 5.4	52.9	3.2	-	-	-	-	20	-	-

Note: Capacity numbers will decrease with the addition of audio visual equipment, head tables, staging, etc.

*Meals are based on rounds of 10.



SOUTH SIDE

Upper Level

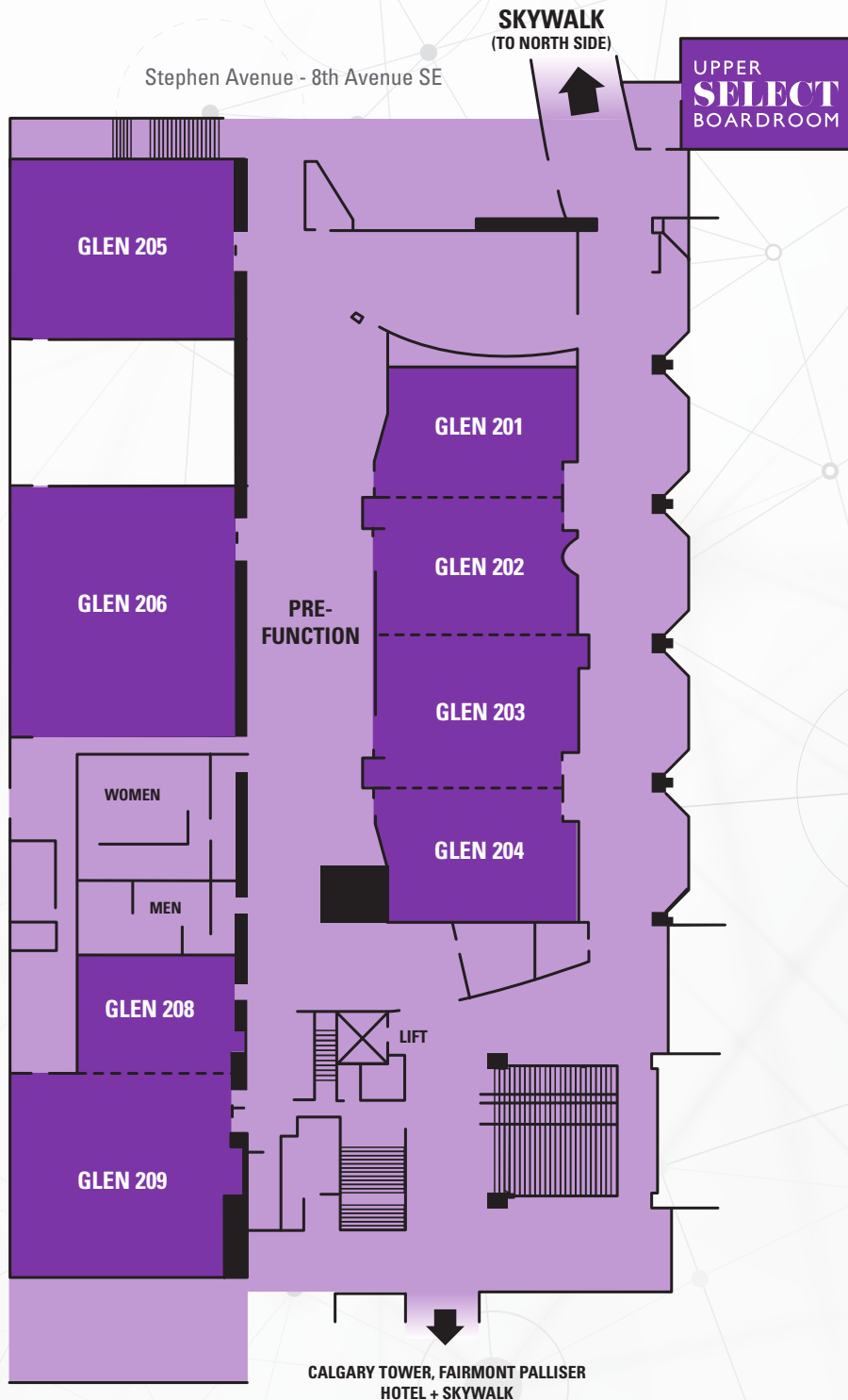

IDEATION CENTRE

- Modern furnishings and bright spaces encourage collaboration
- Ideal for teams of all sizes and requirements with flexible spaces

The Ideation Centre Rooms are ideal for small- to medium-sized gatherings. The main floor location provides easy access to the Calgary Marriott Downtown, as well as to the sights and sounds of the Stephen Avenue mall shopping area.

Flexible room configurations and an adjoining pre-function space make the Ideation Centre Rooms perfect for private board meetings, workshops, or concurrent session planning.

ROOM	CAPACITIES (MAXIMUM)			Signature Setup
	METERS	m ²	CEILING	
South Building				
Ideation 1	8.6 × 7.9	67.9	3.6	40
Ideation 2	8.3 × 11.5	95.9	3.6	40
Ideation 3	8.3 × 5.9	49.5	3.6	40
Ideation 4	7.7 × 7.8	59.5	2.8	40
Ideation 2–3	8.3 × 17.5	145.3	3.6	80



SOUTH SIDE

Main Level



Movable walls are indicated by dashed lines.

MACLEOD

- Most flexible large space available
- Macleod Hall can be used as one contiguous space or 8 smaller spaces
- Large pre-function space

With its movable walls, Macleod Hall offers the greatest flexibility of our larger spaces, and can be easily transformed from one room to seven. It can accommodate events for as few as 30 people and as many as 2,100. It can serve as a plenary hall, banquet hall, ballroom and several breakout rooms all in one.

Macleod Hall's abundant pre-function space is equally versatile, and can be used for registration, buffet service meals, refreshment breaks, receptions, a welcoming bar area or a late night buffet.

ROOM	CAPACITIES (MAXIMUM)			Meals*	Reception	Theatre Style	Class Room	Board Room	Hollow Square	U-Shape	Booth 3 x 3
	METERS	m ²	CEILING								
South Building											
Macleod Hall	38.4 × 47.8	1,835.5	3.6–6.2	1,600	1,786	2,100	1,134	-	-	-	96
*Macleod Hall A	38.4 × 20.1	771.4	6.2	630	440	650	450	-	-	-	36
Macleod Hall A1	11.5 × 8.1	92.8	3.6	80	87	100	54	32	38	30	-
Macleod Hall A2	11.5 × 6.1	70.0	3.6	50	58	60	36	26	34	30	-
Macleod Hall A3	11.5 × 6.1	70.0	3.6	50	58	60	36	26	34	30	-
Macleod Hall A4	11.5 × 7.6	87.6	3.6	80	87	100	54	32	38	30	-
Macleod Hall A5	38.4 × 8.6	330.1	6.2	-	-	-	-	-	-	-	-
Macleod Hall B	38.4 × 8.5	325.4	6.2	240	160	300	207	-	-	-	23
Macleod Hall C	38.4 × 8.5	325.4	6.2	240	160	300	207	-	-	-	23
Macleod Hall D	38.4 × 10.8	413.2	6.2	360	240	370	225	-	-	-	23
Macleod Hall Pre-function	18.9 × 33.1	625.5	3.0	-	512	-	-	-	-	-	-
Macleod Hall A1, 2	11.5 × 14.2	162.9	3.6	130	145	145	96	42	50	42	-
Macleod Hall A1, 2, 3	11.5 × 20.2	232.6	3.6	180	203	200	141	-	-	-	-
Macleod Hall A1, 2, 3, 4	11.5 × 27.9	320.1	3.6	270	296	290	192	-	-	-	-
Macleod Hall A2, 3	11.5 × 12.2	139.7	3.6	100	116	110	90	32	48	38	-
Macleod Hall A2, 3, 4	11.5 × 19.8	227.3	3.6	180	208	200	141	-	-	-	-
Macleod Hall A3, 4	11.5 × 13.7	157.3	3.6	130	151	145	96	42	50	42	-
*Macleod Hall A, B	38.4 × 28.6	1,096.8	3.6–6.2	870	872	1,100	714	-	-	-	57
*Macleod Hall A, B, C	38.4 × 37.0	1,422.3	3.6–6.2	1,120	1,142	1,550	860	-	-	-	78
Macleod Hall B, C	38.4 × 16.9	650.8	6.2	560	544	660	414	-	-	-	44
Macleod Hall B, C, D	38.4 × 27.7	1,064.1	6.2	920	890	1,100	690	-	-	-	63
Macleod Hall C, D	38.4 × 19.2	738.6	6.2	690	617	806	504	-	-	-	42
Pacific 6	5.2 × 7.4	38.6	-	20	29	25	12	14	18	14	-
Macleod Hall E1	14.3 × 9.5	136.7	3.8	100	115	120	60	32	38	34	-
Macleod Hall E2	14.3 × 8.9	127.9	3.8	80	107	100	54	32	38	34	-
Macleod Hall E3	14.3 × 8.9	127.9	3.8	80	107	100	54	32	38	34	-
Macleod Hall E4	14.3 × 8.9	127.9	3.8	80	107	100	54	32	38	34	-
Macleod E Pre-function	34.0 × 8.2	279.9	3.8	-	171	-	-	-	-	-	-

Note: Capacity numbers will decrease with the addition of audio visual equipment, head tables, staging, etc.

*Meals based on rounds of 10. *Macleod Hall A includes A1, A2, A3, A4.

SOUTH SIDE

Lower Level

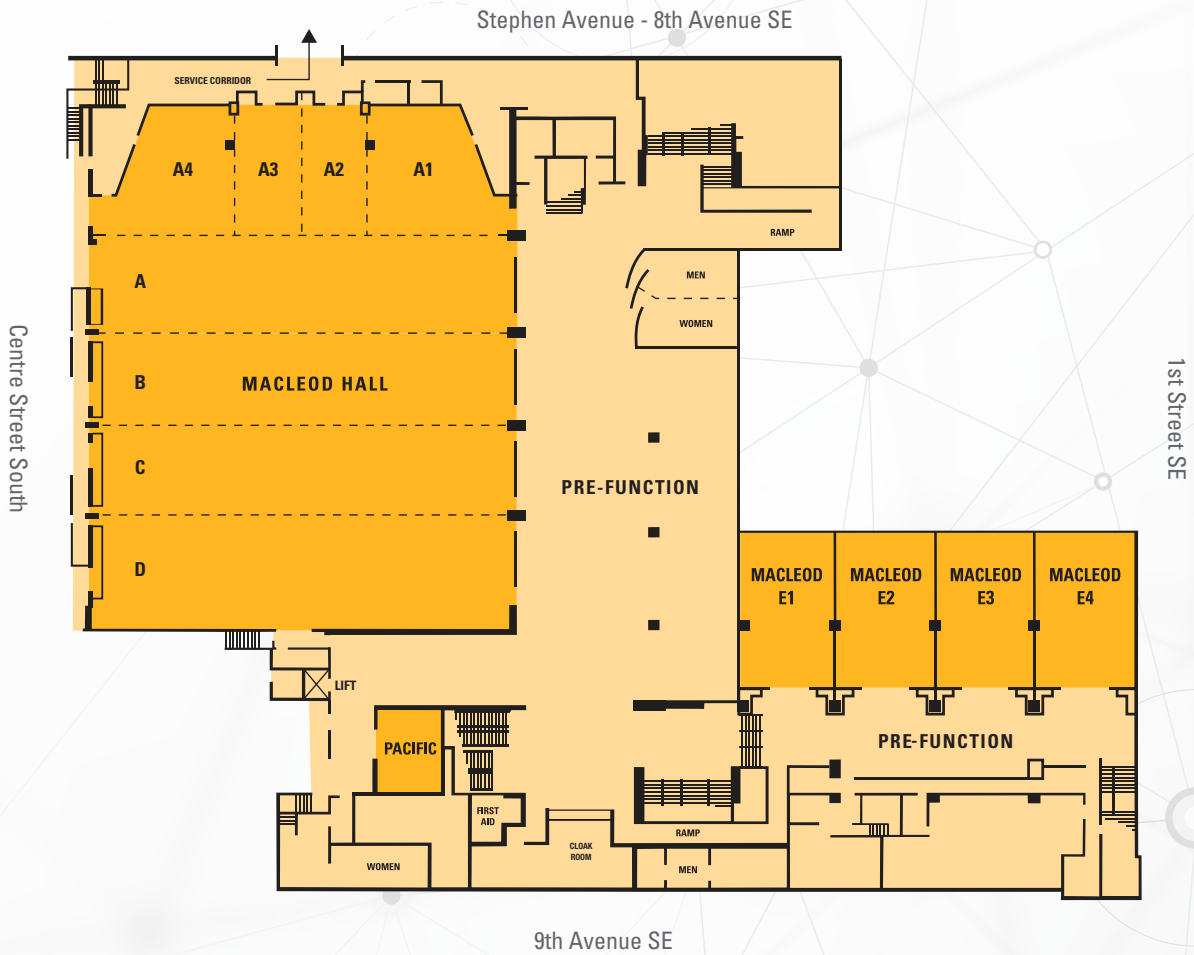

MACLEOD



Movable walls are indicated by dashed lines.

120 Ninth Avenue SE
Calgary, Alberta
Canada T2G 0P3

Toll Free 00+1+800.822.2697
Fax 403.261.8510
sales@calgary-convention.com
calgary-convention.com

calgary TELUS convention
centre
be part of the energy

