



Facility Guide

calgary TELUS convention
centre
be part of the energy™

FOR INNOVATIVE MEETINGS...



Upper Select Boardroom

A modern, executive-style setting, the Upper Select Boardroom has been designed with the corner office in mind. Featuring current teleconferencing abilities, bring your team together from around the world to engage in your biggest corporate challenges.

UPPER SELECT BOARDROOM

Glen Rooms, South Side,
Upper Level



Main Level Boardroom

A private and modern retreat in the heart of downtown Calgary, the Main Level Boardroom has been designed to foster productive small team meetings. From corporate presentations to strategy sessions, your team can get away from the usual boardroom setup to move big ideas forward.

MAIN LEVEL BOARDROOM

TELUS Rooms, North Side,
Main Level



Colab

Collaboration is the cornerstone. We've designed the Colab space to encourage groups to meet differently. From strategy sessions to intensive collaborative work, take advantage of our unique space to create new ideas.

THE colab

TELUS Rooms, North Side,
Main Level



Ideation Centre

Four unique spaces set apart from the main hustle and bustle of larger events, allowing you and your team to focus in small—or larger—groups. The modern furnishings and bright space are complemented with our attentive service, making your next group session truly engaging.

Ideation Centre

South Side,
Main Level

... AT THE CENTRE.

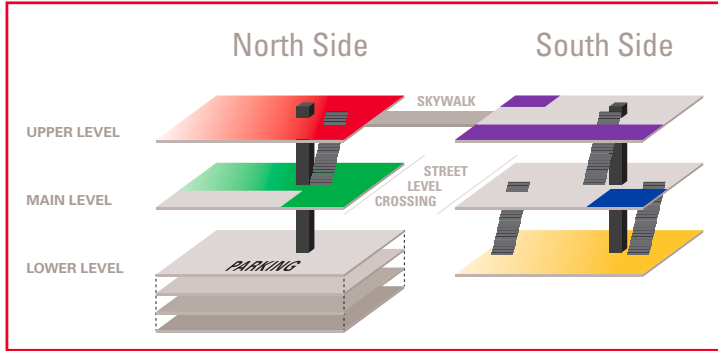

Located across three levels in two connected buildings, the Calgary TELUS Convention Centre combines flexible spaces with our attentive service to provide a truly memorable experience for you and your attendees and guests.

CTCC Legend

E Elevator

F Freight Elevator

G Guest Services

W Washrooms



North Side

EXHIBITION HALL
Upper Level

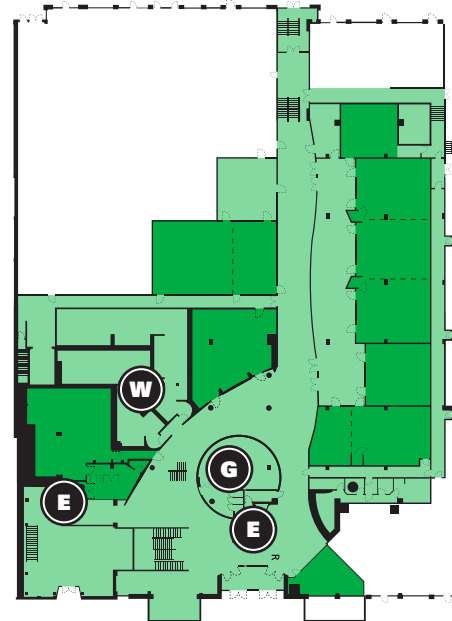
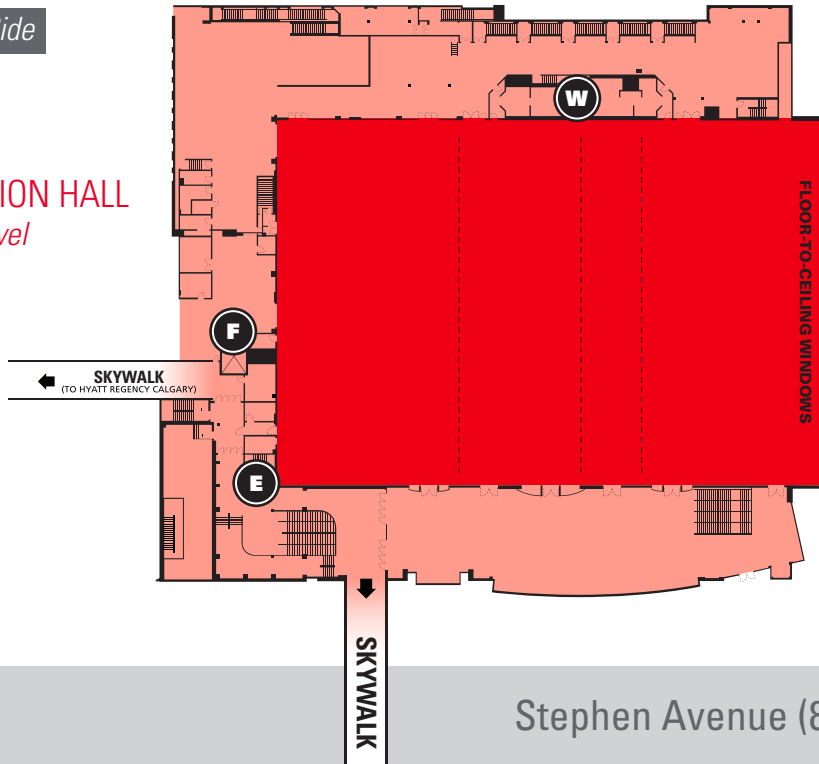

TELUS
Main Level

1st Street SE

Stephen Avenue (8th Avenue SE)

Stephen Avenue (8th Avenue SE)

Centre Street

1st Street SE

GLEN
Upper Level

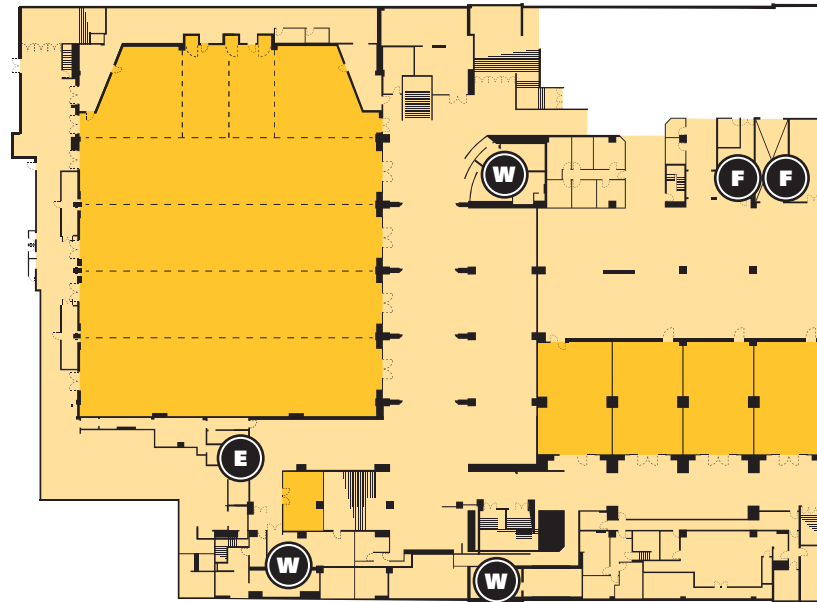

MACLEOD
Lower Level

South Side

IDEATION
CENTRE
Main Level



9th Avenue SE



Calgary TELUS Convention Centre is located at the centre of Calgary's downtown core, a short walk to more than 4,000 three- and four-star hotel rooms. For your convenience, you can even take advantage of Calgary's +15 Elevated Skywalk for direct access to 1100 of those rooms.

FACILITY MAP

EXHIBITION HALL

North Side *Upper Level*

- Our largest space available for your grandest event
- Floor-to-ceiling windows provide ample natural lighting and inspiring views
- Can be partitioned into three separate halls

Exhibition Hall CDE offers 47,000 square feet of free-span space, which can be divided into three multi-purpose halls. This space has hosted keynote speakers of international acclaim: prime ministers, royalty, former U.S. presidents and renowned minds. It has also hosted hundreds of tradeshow, galas and award ceremonies.

Its spacious and elegant pre-function area can be used for display space, informal gatherings and registration as well as for receptions and refreshment breaks. The pre-function area's floor-to-ceiling east- and south-facing windows provide inspiring views.

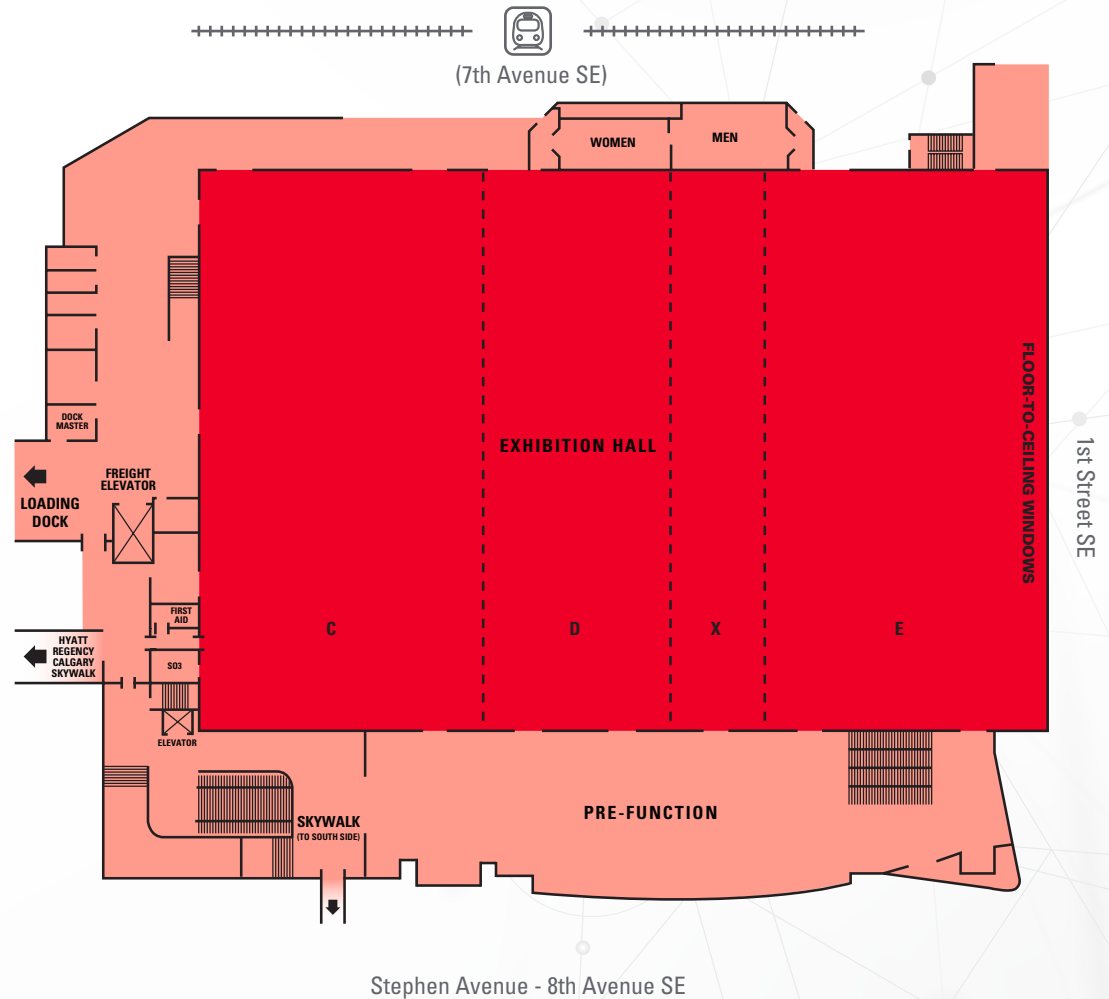

Movable walls are indicated by dashed lines.



ROOM	CAPACITIES (MAXIMUM)			Meals*	Reception	Theatre Style	Class Room	Booth 10 × 10
	FEET	ft²	CEILING					
North Building								
Hall CDE	177.2 × 265.5	47,047	29.9	3,600	3,642	4,000	2,700	253
Hall C	177.2 × 89.4	15,842	29.9	1,080	1,240	1,300	900	86
Hall D	177.2 × 59.3	10,508	29.9	720	855	850	600	61
Hall E	177.2 × 87.7	15,540	29.9	900	923	1,300	900	90
Hall CD	177.2 × 148.7	26,350	29.9	1,980	2,108	2,200	1,600	141
Hall CDX	177.2 × 177.8	31,506	29.9	2,340	2,507	2,600	1,800	169
Hall DX	177.2 × 88.4	15,664	29.9	1,080	1,268	1,300	900	89
Hall DXE	177.2 × 176.1	31,205	29.9	2,160	2,190	2,600	1,800	173
Hall XE	177.2 × 116.8	20,697	29.9	1,260	1,323	1,750	1,200	118
Pre-Function	193.1 × 43.0	8,323	22.0	350	786	-	-	20
North Building Show Offices								
Show Office 1	12.6 × 23.3	294	7.8					
Show Office 2	14.8 × 11.3	167	7.8					
Show Office 3	14.8 × 8.0	118	7.7					
Green Room	23.8 × 19.9	474	7.0					

Note: Capacity numbers will decrease with the addition of audio visual equipment, head tables, staging, etc.

*Meals are based on rounds × 12.

North Side Main Level

- Highly flexible for gatherings of all sizes
- Guest Services provides business services to attendees requiring last minute assistance
- Home to Colab and Main Level Boardroom

The TELUS Rooms provide the ultimate in flexibility for a meeting or conference. Ideal for events that require concurrent session planning, the TELUS Rooms have flexible room configurations and a spacious foyer.

Adjacent pre-function areas are glass-enclosed for privacy while keeping the space open and welcoming. It's the ideal location for registration, refreshments or receptions.



Stephen Avenue - 8th Avenue SE

Movable walls are indicated by dashed lines.



ROOM	CAPACITIES (MAXIMUM)			Meals*	Reception	Theatre Style	Class Room	Board Room	Hollow Square	U-Shape
	FEET	ft²	CEILING							
North Building										
TELUS 101	27.5 × 16.3	448	10.2	30	43	35	24	18	22	20
TELUS 102	27.5 × 35.4	974	10.2	60	77	86	54	26	36	30
TELUS 103	30.0 × 28.7	861	10.0	50	66	72	45	26	30	24
TELUS 104	34.8 × 29.8	1,037	10.2	60	83	77	54	26	36	27
TELUS 105	34.8 × 27.4	954	10.2	60	74	91	54	26	36	27
TELUS 106	34.8 × 28.5	992	10.2	60	69	77	54	26	36	27
TELUS 107	25.0 × 26.0	650	7.3	40	47	50	30	18	26	22
TELUS 108	34.6 × 22.2	768	9.3	60	60	56	36	24	24	24
TELUS 109	30.4 × 27.6	839	9.3	50	57	72	36	26	30	24
TELUS 110 (Coat Check)	29.3 × 39.5	1,157	10.1	80	114	85	60	34	36	30
TELUS 101–102	27.5 × 51.7	1,422	10.2	110	120	130	84	48	50	46
TELUS 104–105	34.8 × 57.2	1,991	10.2	130	157	175	90	50	52	44
TELUS 104–106	34.8 × 85.7	2,982	10.2	200	226	245	162	74	82	74
TELUS 105–106	34.8 × 55.9	1,945	10.2	130	143	168	90	50	52	44
TELUS 108–109	34.6 × 49.8	1,723	9.3	110	116	131	81	44	48	44
TELUS Pre-function (101–107)	20.9 × 116.6	2,437	11.0	-	189	-	-	-	-	-
TELUS Pre-function (108–109)	25.9 × 19.0	492	11.2	-	38	-	-	-	-	-
Colab	43.2 × 40.3	1,741	8.3	-	-	-	40	-	-	-
Main Level Boardroom	15.25 × 20.6	314	-	-	-	-	-	10	-	-

Note: Capacity numbers will decrease with the addition of audio visual equipment, head tables, staging, etc.

*Meals are based on rounds × 10.

South Side *Upper Level*

- Eight individual rooms available
- Partition walls can be moved to create customized space
- Private pre-function space available

The eight room upper-floor Glen Rooms offer flexible configurations and a large pre-function space spanning nearly the length of the section.

Bright, airy interiors give the Glen Meeting Rooms and pre-function space a warm, comfortable feel.

The Glen pre-function space is surrounded by a skylit area—ideal for registration, a pre-meeting breakfast or a lunch buffet.

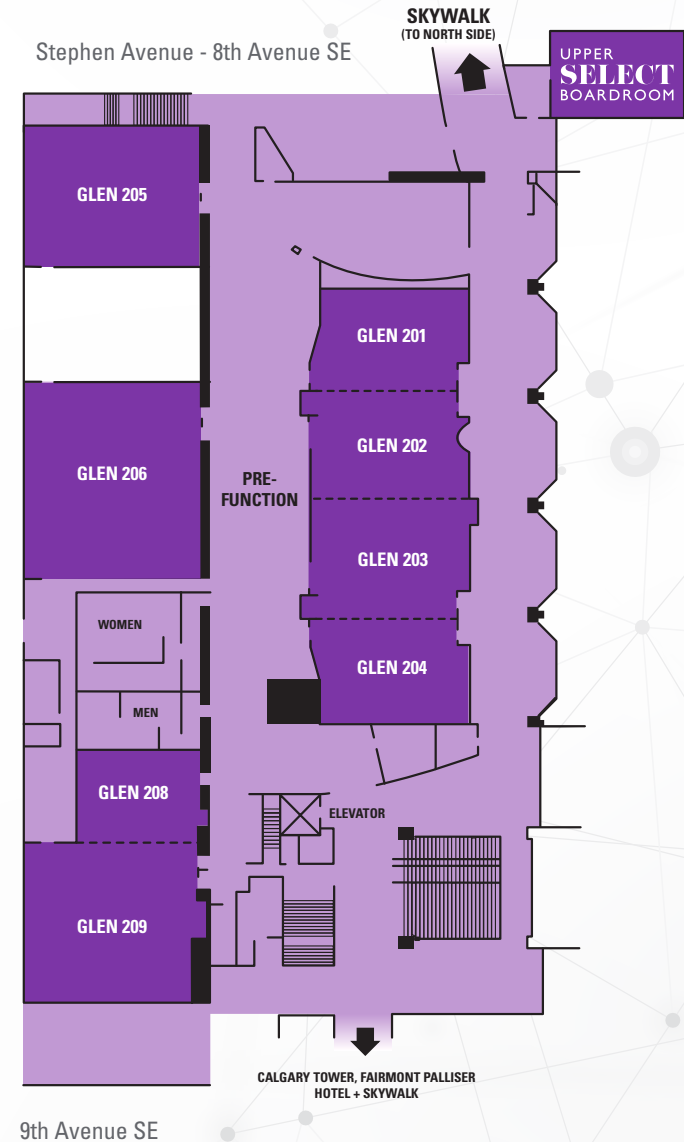

Movable walls are indicated by dashed lines.



ROOM	CAPACITIES (MAXIMUM)			Meals*	Reception	Theatre Style	Class Room	Board Room	Hollow Square	U-Shape
	FEET	ft²	CEILING							
South Building										
Glen 201	37.3 × 27.3	1,018	9.9	80	69	90	45	32	38	33
Glen 202	38.0 × 27.6	1,049	9.9	80	74	90	45	32	38	33
Glen 203	38.2 × 27.7	1,058	9.9	80	74	90	45	32	38	33
Glen 204	36.7 × 27.3	1,002	9.9	80	74	90	45	32	38	33
Glen 205	40.3 × 34.3	1,382	8.9	90	107	100	72	32	46	36
Glen 206	41.1 × 48.6	1,997	8.9	150	155	176	120	44	60	48
Glen 208	31.5 × 23.4	737	8.9	50	56	63	30	22	30	24
Glen 209	38.4 × 39.8	1,528	8.9	90	121	130	78	30	42	36
Glen 201–202	37.3 × 54.9	2,048	9.9	160	143	180	96	44	58	55
Glen 201–203	37.3 × 82.6	3,081	9.9	240	217	270	144	66	-	-
Glen 201–204	37.3 × 109.9	4,099	9.9	320	291	360	189	88	-	-
Glen 202–203	38.0 × 55.3	2,101	9.9	160	148	180	105	44	58	55
Glen 202–204	38.0 × 82.6	3,139	9.9	240	222	270	144	66	-	-
Glen 203–204	38.2 × 55.0	2,101	9.9	160	148	180	96	44	58	55
Glen 208–209	31.5 × 63.2	1,991	8.9	150	177	200	126	50	60	54
Glen Pre-function	25.0 × 125.0	3,125	9.8 - 25.3	-	242	-	-	-	-	-
Upper Select Boardroom	32.0 × 17.8	570	10.6	-	-	-	-	20	-	-

Note: Capacity numbers will decrease with the addition of audio visual equipment, head tables, staging, etc.

*Meals are based on rounds × 10.

South Side *Main Level*

- Modern furnishings and bright spaces encourage collaboration
- Ideal for teams of all sizes and requirements with flexible spaces

The Ideation Centre Rooms are ideal for small- to medium-sized gatherings. The main floor location provides easy access to the Calgary Marriott Downtown, as well as to the sights and sounds of the Stephen Avenue mall shopping area.

Flexible room configurations and an adjoining pre-function space make the Ideation Centre Rooms perfect for private board meetings, workshops, or concurrent session planning.

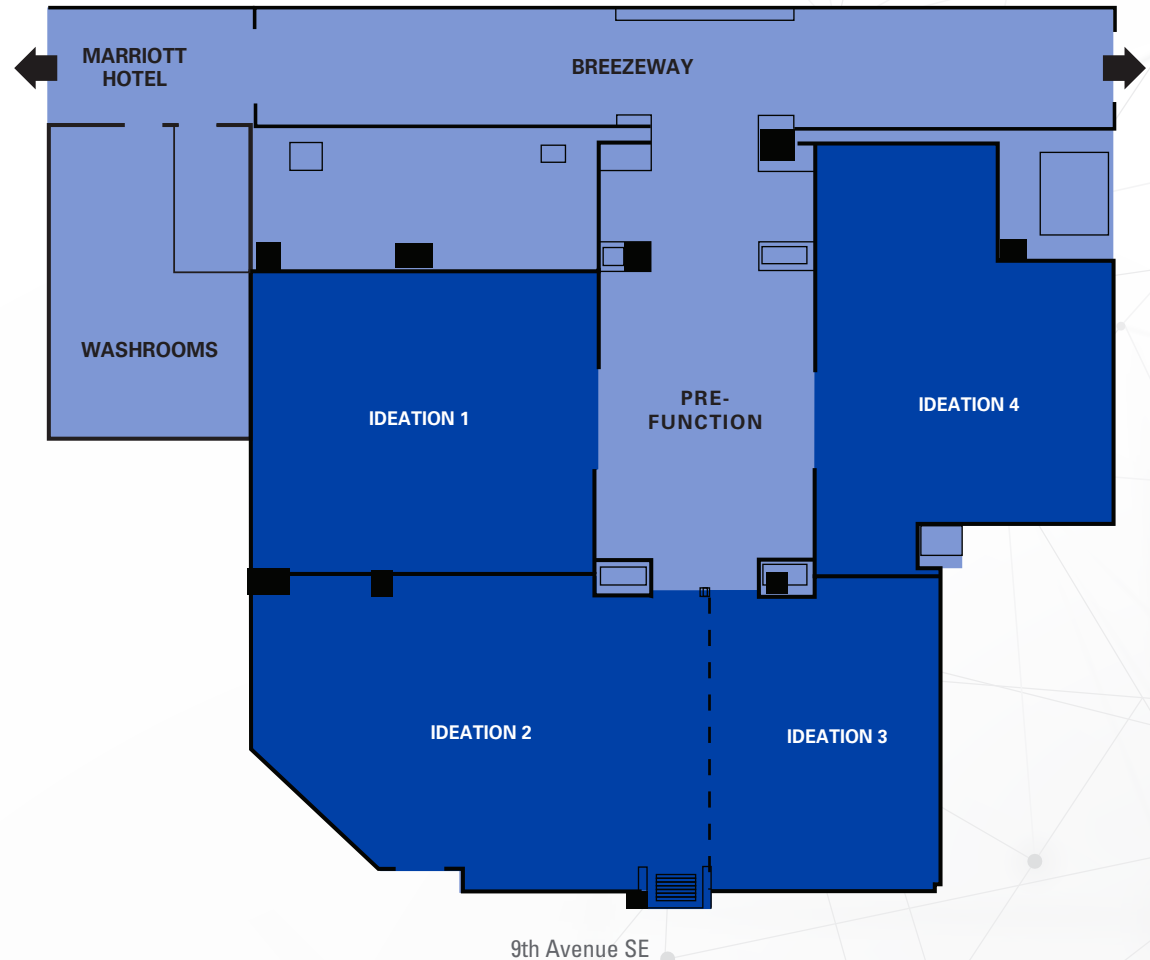

Movable walls are indicated by dashed lines.



ROOM	CAPACITIES (MAXIMUM)			
	FEET	ft ²	CEILING	Signature Setup
South Building				
Ideation 1	28.1 × 26.0	731	11.8	40
Ideation 2	27.3 × 37.8	1,032	11.8	40
Ideation 3	27.3 × 19.5	532	11.8	40
Ideation 4	25.1 × 25.5	640	9.4	40
Ideation 2–3	27.3 × 57.3	1,564	11.8	80



South Side Lower Level

- Most flexible large space available
- Macleod Hall can be used as one contiguous space or eight smaller spaces
- Large pre-function space

With its movable walls, Macleod Hall offers the ultimate in flexibility, and can be easily transformed from one room to seven. It can accommodate events for as few as 30 people and as many as 2,100. It can serve as a plenary hall, banquet hall, ballroom and several breakout rooms all in one.

Macleod Hall's abundant pre-function space is equally versatile, and can be used for registration, buffet service meals, refreshment breaks, receptions, or a welcoming bar area.

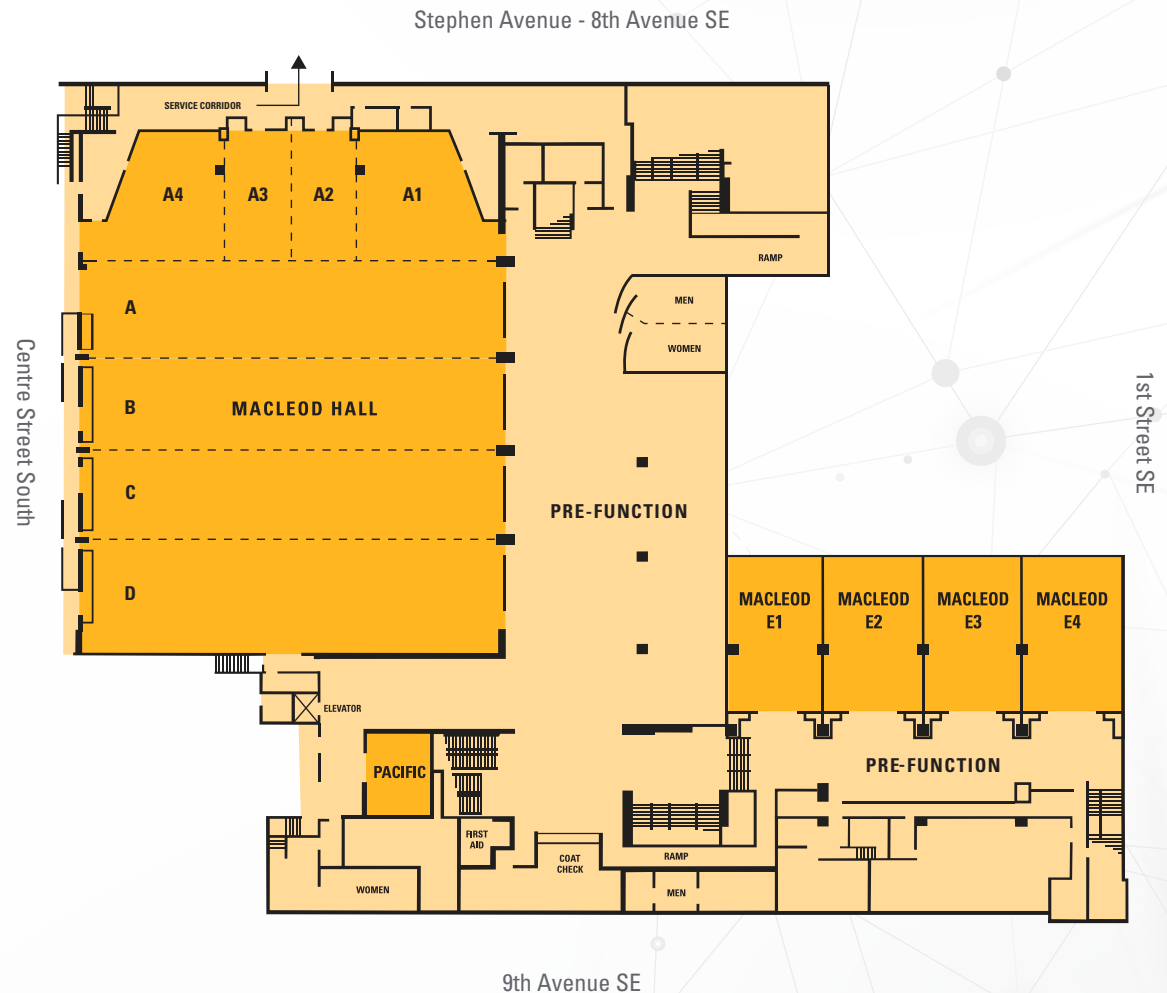



Note: Capacity numbers will decrease with the addition of audio visual equipment, head tables, staging, etc.

†Meals based on rounds × 10.

***Macleod Hall A includes A1, A2, A3, A4.**

ROOM	CAPACITIES (MAXIMUM)			Meals*	Reception	Theatre Style	Class Room	Board Room	Hollow Square	U-Shape	Booth 10 × 10
	FEET	ft²	CEILING								
South Building											
Macleod Hall	126.0 × 156.8	19,757	11.9–20.3	1,600	1,786	2,100	1,134	-	-	-	96
*Macleod Hall A	126.0 × 65.9	8,303	20.3	630	440	650	450	-	-	-	36
Macleod Hall A1	37.7 × 26.5	999	11.9	80	87	100	54	32	38	30	-
Macleod Hall A2	37.7 × 20.0	754	11.9	50	58	60	36	26	34	30	-
Macleod Hall A3	37.7 × 20.0	754	11.9	50	58	60	36	26	34	30	-
Macleod Hall A4	37.7 × 25.0	943	11.9	80	87	100	54	32	38	30	-
Macleod Hall A5	126.0 × 28.2	3,553	20.3	-	-	-	-	-	-	-	-
Macleod Hall B	126.0 × 27.8	3,503	20.3	240	160	300	207	-	-	-	23
Macleod Hall C	126.0 × 27.8	3,503	20.3	240	160	300	207	-	-	-	23
Macleod Hall D	126.0 × 35.3	4,448	20.3	360	240	370	225	-	-	-	23
Macleod Hall Pre-function	62.0 × 108.6	6,733	10.0	-	512	-	-	-	-	-	-
Macleod Hall A1, 2	37.7 × 46.5	1,753	11.9	130	145	145	96	42	50	42	-
Macleod Hall A1, 2, 3	37.7 × 66.4	2,503	11.9	180	203	200	141	-	-	-	-
Macleod Hall A1, 2, 3, 4	37.7 × 91.4	3,446	11.9	270	296	290	192	-	-	-	-
Macleod Hall A2, 3	37.7 × 39.9	1,504	11.9	100	116	110	90	32	48	38	-
Macleod Hall A2, 3, 4	37.7 × 64.9	2,447	11.9	180	208	200	141	-	-	-	-
Macleod Hall A3, 4	37.7 × 44.9	1,693	11.9	130	151	145	96	42	50	42	-
*Macleod Hall A, B	126.0 × 93.7	11,806	11.9–20.3	870	872	1,100	714	-	-	-	57
*Macleod Hall A, B, C	126.0 × 121.5	15,309	11.9–20.3	1,120	1,142	1,550	860	-	-	-	78
Macleod Hall B, C	126.0 × 55.6	7,006	20.3	560	544	660	414	-	-	-	44
Macleod Hall B, C, D	126.0 × 90.9	11,453	20.3	920	890	1,100	690	-	-	-	63
Macleod Hall C, D	126.0 × 63.1	7,951	20.3	690	617	806	504	-	-	-	42
Pacific 6	17.1 × 24.3	416	-	20	29	25	12	14	18	14	-
Macleod Hall E1	47.0 × 31.3	1,471	12.5	100	115	120	60	32	38	34	-
Macleod Hall E2	47.0 × 29.3	1,377	12.5	80	107	100	54	32	38	34	-
Macleod Hall E3	47.0 × 29.3	1,377	12.5	80	107	100	54	32	38	34	-
Macleod Hall E4	47.0 × 29.3	1,377	12.5	80	107	100	54	32	38	34	-
Macleod E Pre-function	111.6 × 27.0	3,013	12.5	-	171	-	-	-	-	-	-

120 Ninth Avenue SE
Calgary, Alberta
Canada T2G 0P3

Main 403.261.8500
Toll Free 800.822.2697
Fax 403.261.8510
sales@calgary-convention.com
calgary-convention.com

calgary TELUS convention
centre
be part of the energy™

