

Think beyond the present Think for the next 10 years.

When it comes to your workplace, it's not about one size fits all. It's about addressing the specific needs of your business and your people.

[Contact us to learn more](#)

COVID has dramatically shaken up the way things are done. As a global service provider, we're leveraging our industry knowledge and global supply chains to assist our clients and partners with their workplace needs, for the short, and the long term.

With global talent collaborating across Strategy, Design, Pre-construction and Construction, Unispace is a one-stop-shop for your integrated workplace solution.

What is different about our offering?

We are,
One team.
One cost.
One integrated solution.



From providing hand sanitizing stations to a full office design and construction build out, Unispace has a solution for you.

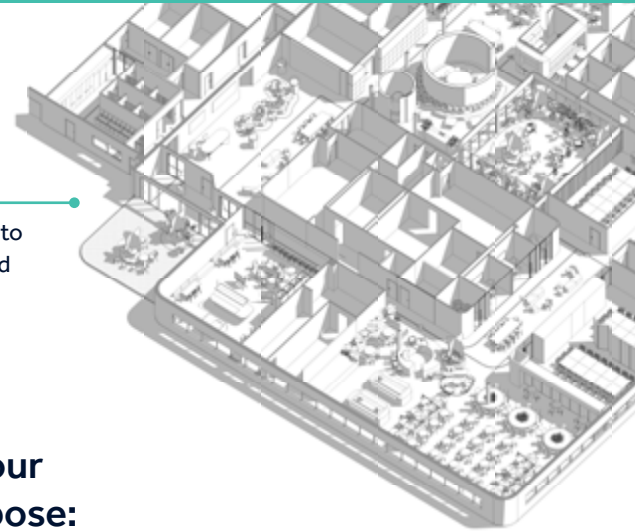

We take data driven solutions and apply them to your workplace, creating a space that is truly fit for purpose:

We always begin with your specific business considerations and goals:

- Business planning
- Workplace optimization
- Changes to ways of working
- Change management
- Return to work implementation
- Business operations
- Safe distancing
- Wellbeing

And create service scenarios directly in relation to your needs:

Select service options we're providing include:

- **Return to work on day 1:** The most minimal checklist for a fast return to work
- **In flight design:** For clients that are midway through a project
- **Retro & future fitting:** For clients with a recent project that require a more robust return to work strategy
- **Full new design:** A full offering creating the workplace of the future for our new post-COVID reality

Think beyond the present Think for the next 10 years.

Contact us to learn more

Selected interventions:



1

Biophilia

Lead time: Medium
Cost: \$\$

Freshen the arrival experience with landscape planting and seating to provide a sense of welcoming, along with support of carbon reduction



3

Health Screening

Lead time: Medium
Cost: \$\$

Proactive health measures with daily temperature screening on arrival to maintain a healthy workforce



9

Design Flow

Lead time: Medium
Cost: \$\$

Both aesthetically pleasing and practical, curved feature walls are an effective way of reducing human-to-human contact, whilst also bringing a modern touch



15

Density

Lead time: Medium
Cost: \$\$

Less dense workflow with all workstations assigned to ensure phones, computers and desks are not shared. Sit to stand desking to support wellbeing and a spine desk system to scale up and scale down workforce



21

Hygiene Stations

Lead time: Short
Cost: \$

Hygiene station to introduce greater opportunities for hand washing and sanitizing. Including antibacterial desk and office wipes, contactless dispensing hand soap and sanitizer



26

Contactless

Lead time: Short
Cost: \$

Contactless payment methods at the cafeteria to minimise human touchpoints



30

Interactive Technology

Lead time: Medium
Cost: \$\$

Interactive digital feature wall allows colleagues to communicate and connect from home and across the globe

LEGEND
\$: low investment
\$\$: moderate investment
\$\$\$: high investment

