

How to add recommended vendors and affiliates

1

Login to your **SavvyCard Account Dashboard** using your email address associated with your account and the password.

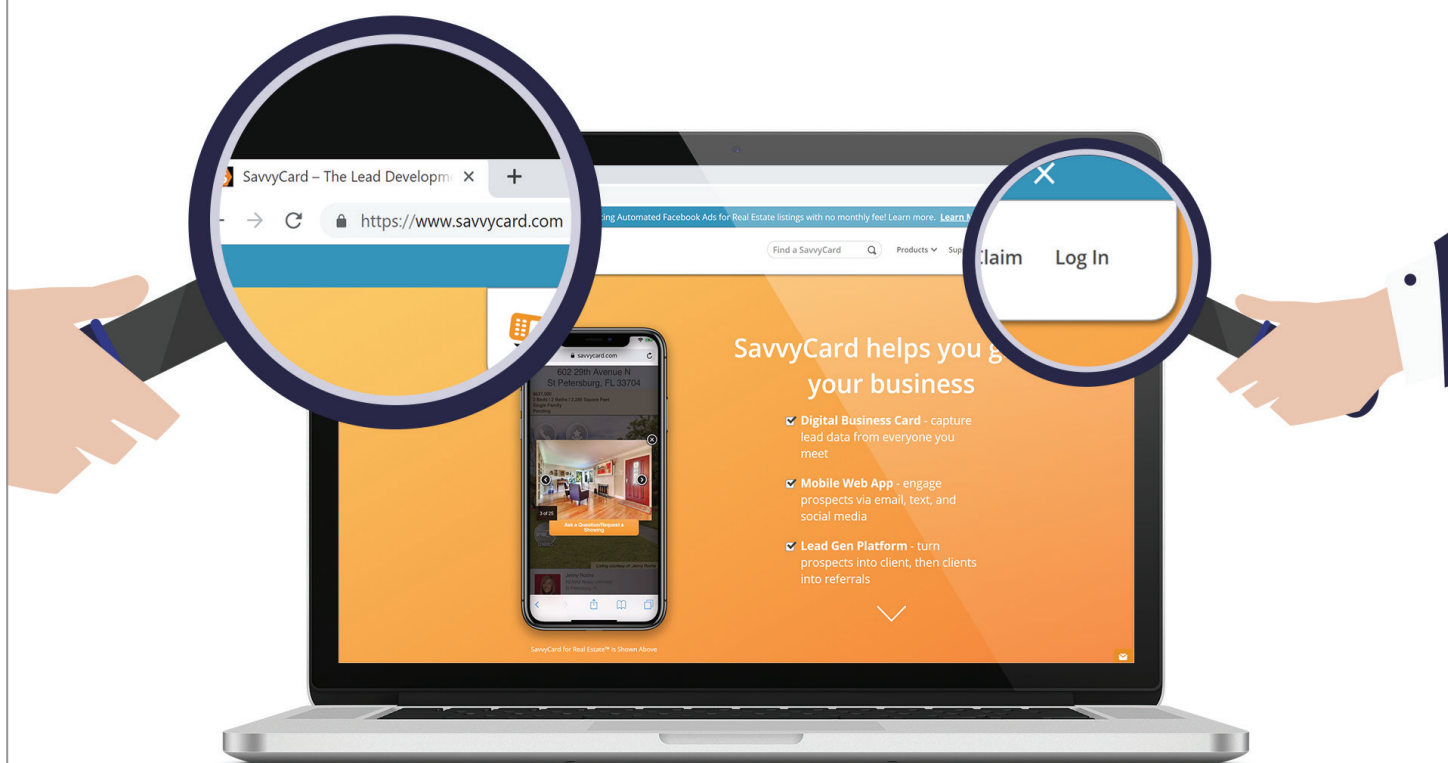

How to **add recommended vendors and affiliates**

2

Click on **Edit this Card**.

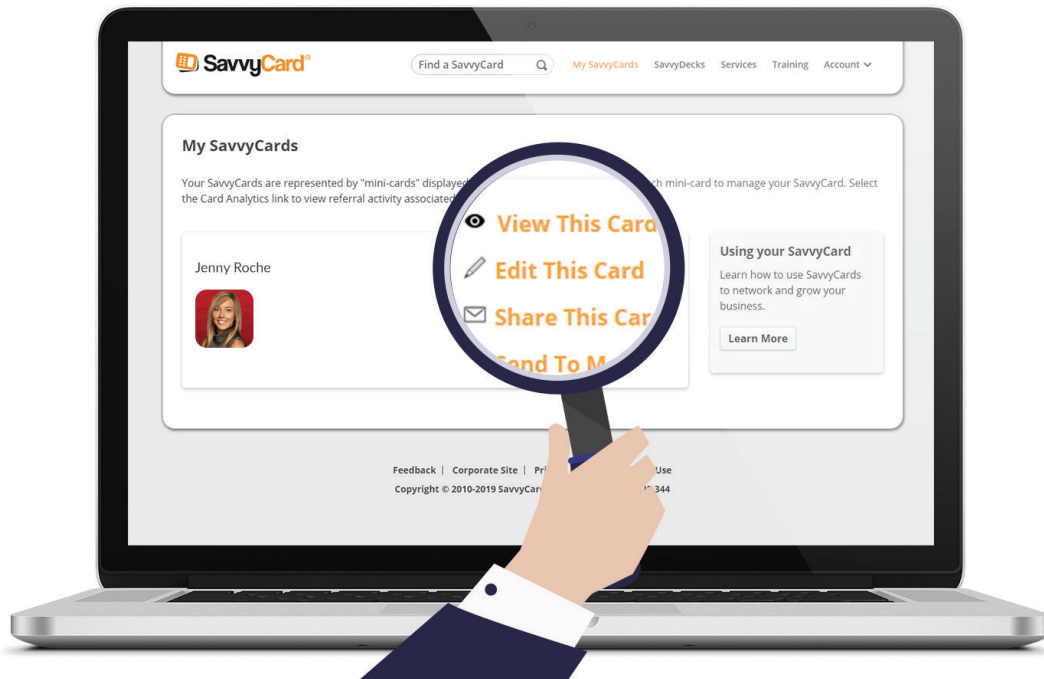

How to add recommended vendors and affiliates

3

Click on the **Buttons Tab** at the top of the page and choose the button you wish to turn on or off from the full list of buttons on the right side of the page.



How to **add recommended vendors and affiliates**

4

Click on the **Recommend Tab** from the list.

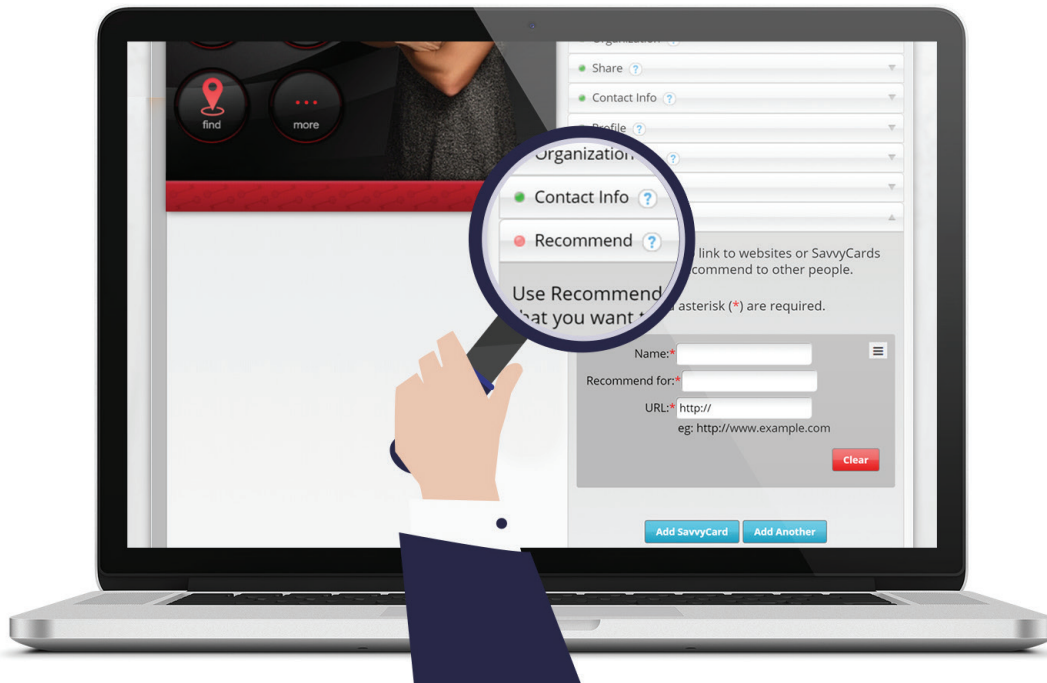

How to **add recommended vendors and affiliates**

5

Enter the name of the **vendor or affiliate** in name field.

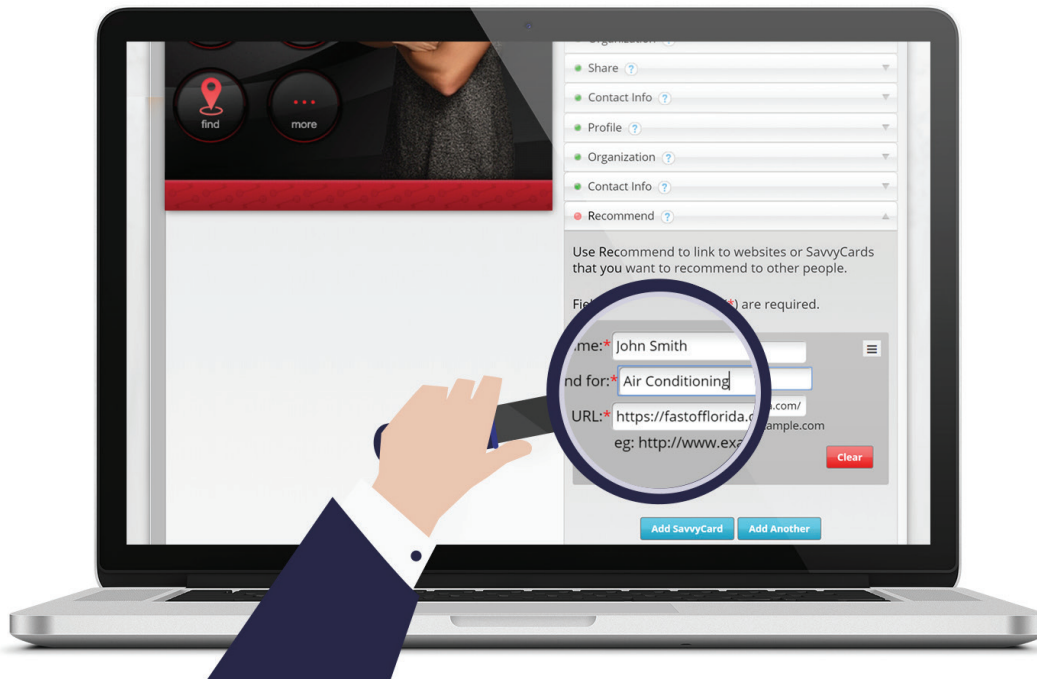

How to add recommended vendors and affiliates

6

Enter what you recommend them for in the **'recommended for'** field.

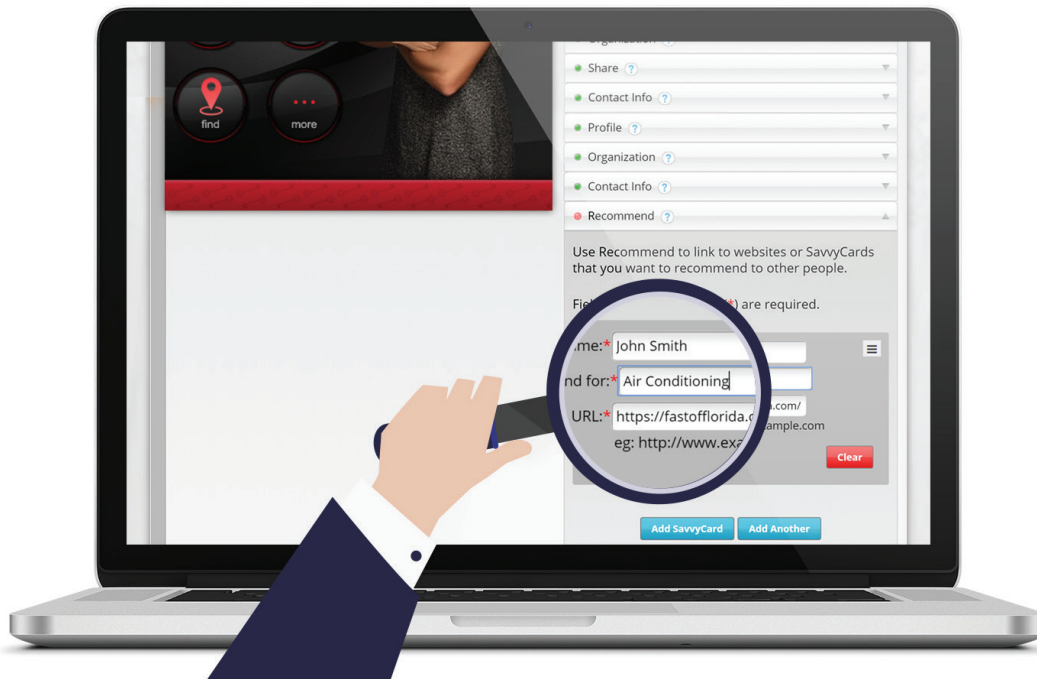

How to add recommended vendors and affiliates

7

Enter the web address for the vendor or affiliate in the **URL** field

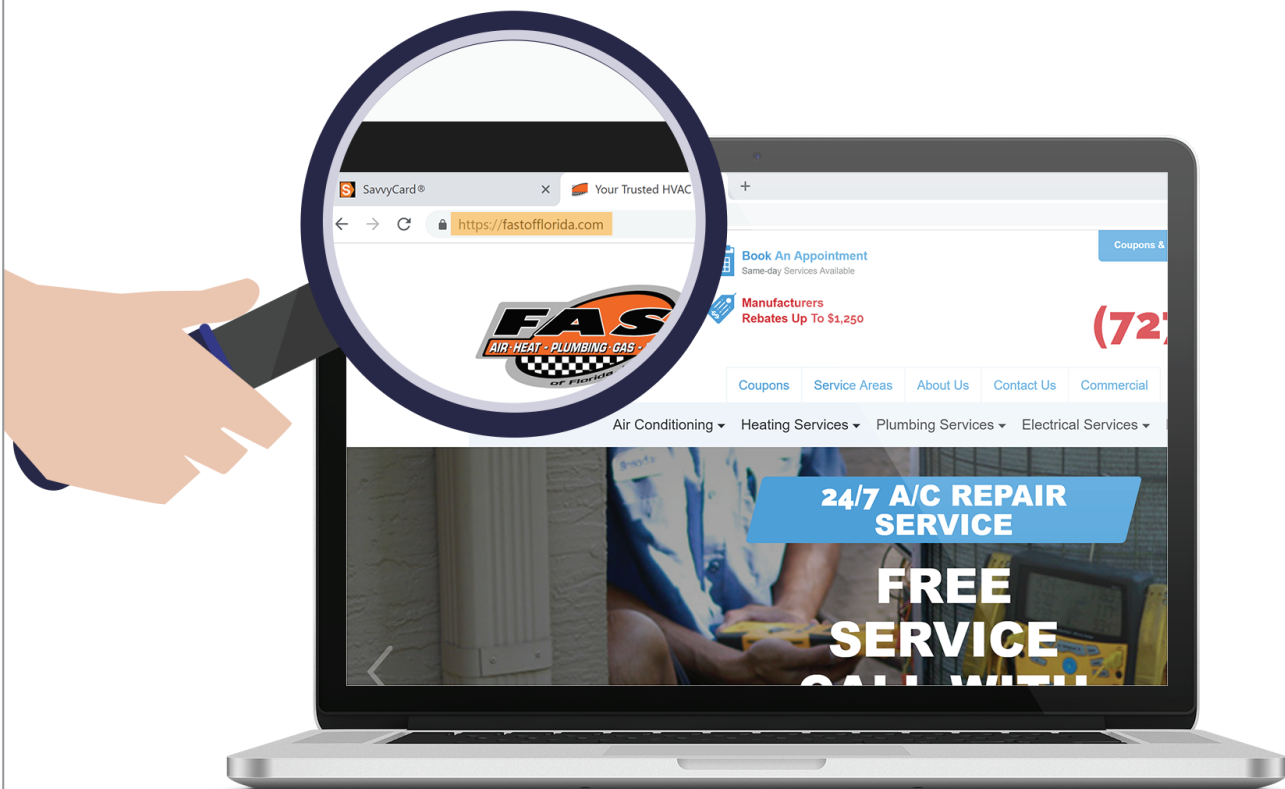

How to **add recommended vendors and affiliates**

8

Choose 'show this button on my card' and Click **'Save'**

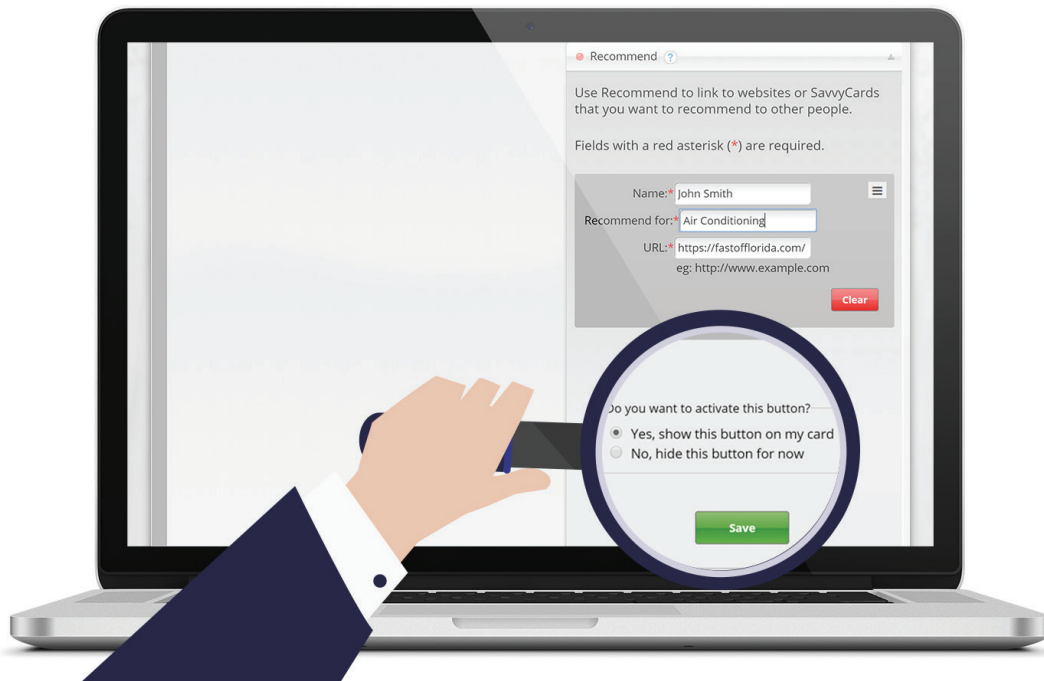

How to **add recommended vendors and affiliates**

9

Choose **Add Another** to add additional valuable resources.

