

**SECURED BY MFC.com**

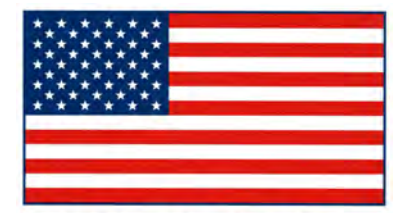

**MADE IN THE USA**  
 IRONTON, OH | WORTHINGTON, KY | WURTLAND, KY

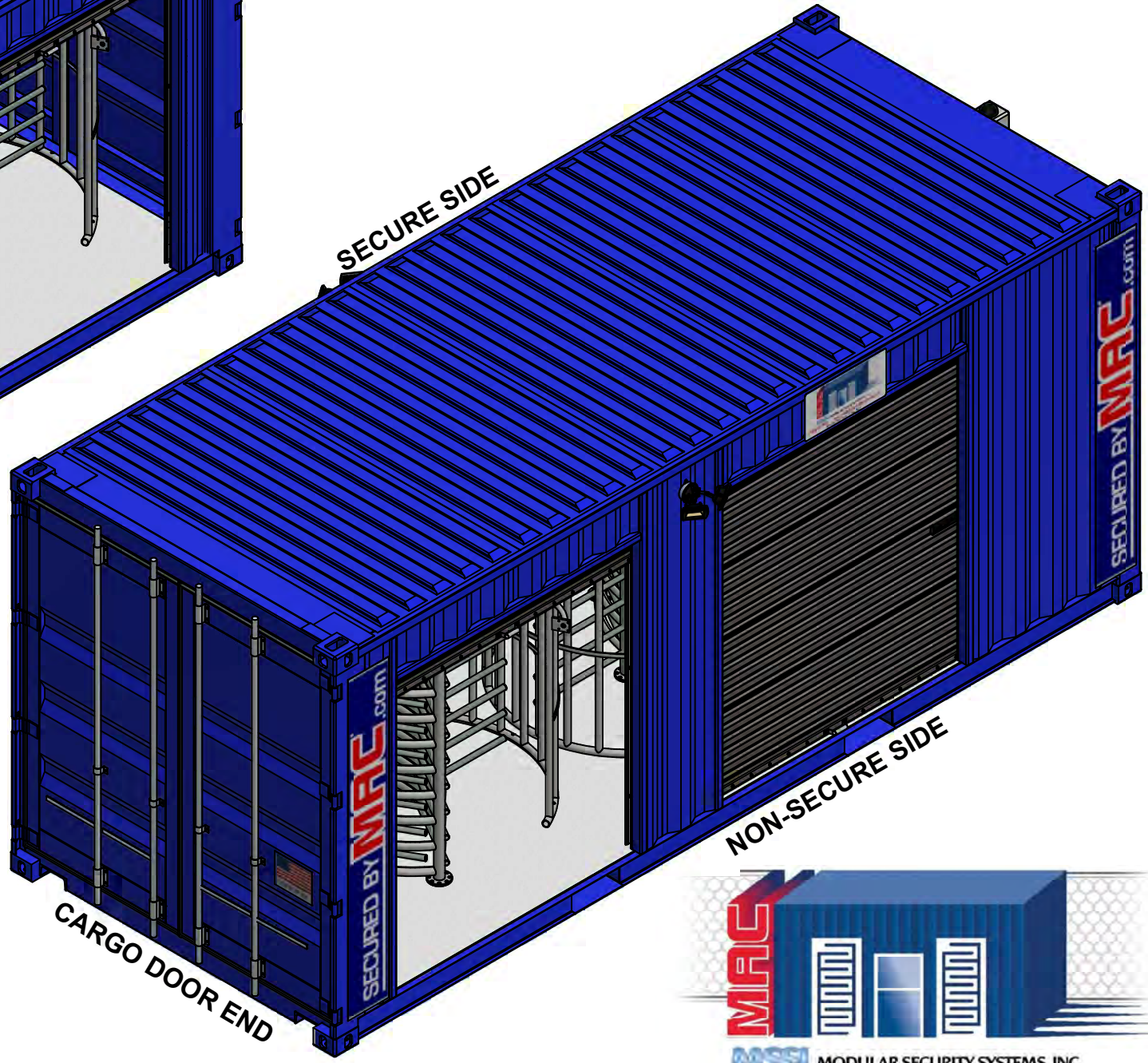
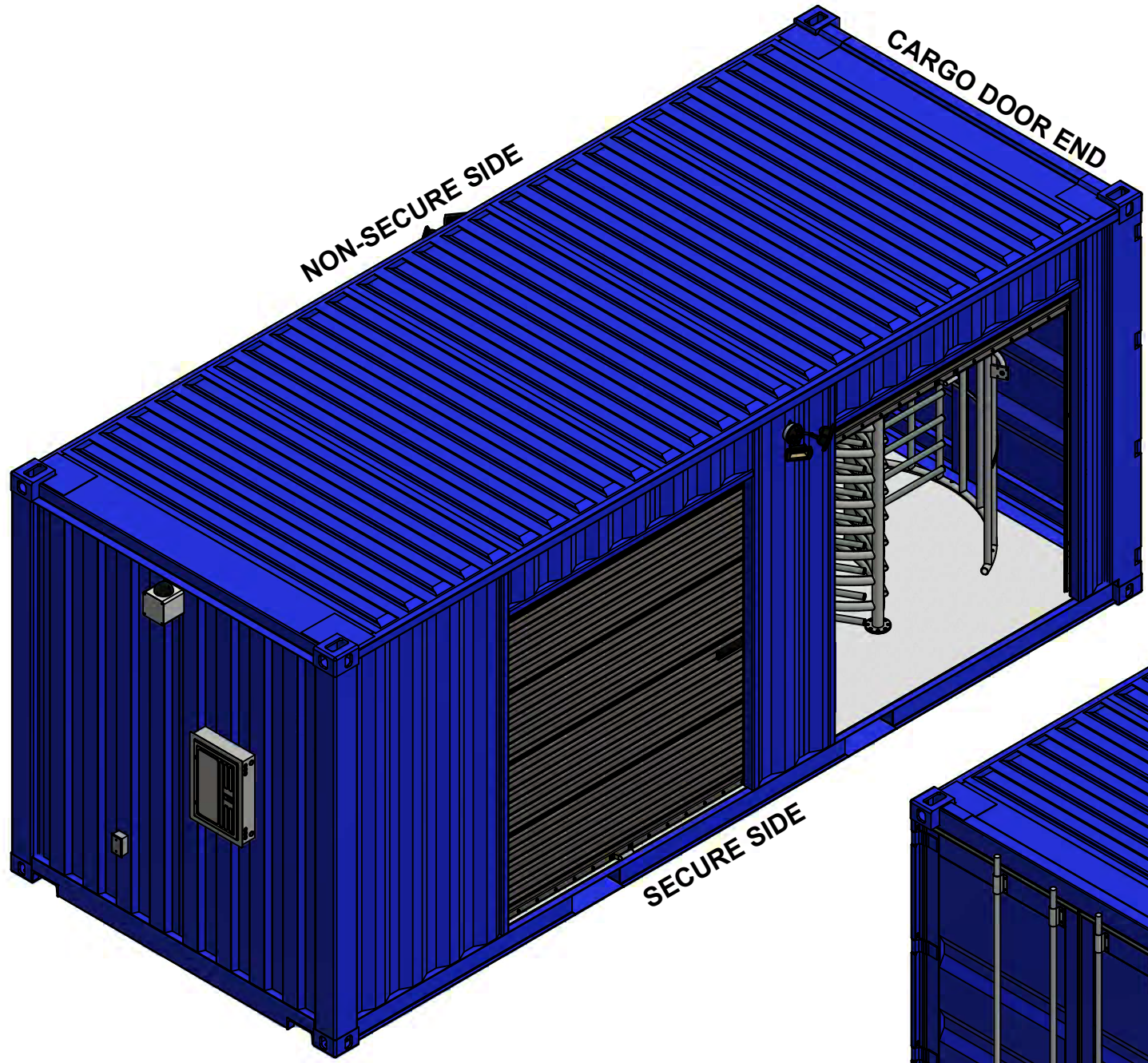

THIRD ANGLE PROJECTION	SHEET SIZE
	ANSI D

**ISOMETRIC SHEETS - OVERALL 1**

THIS MSSI PRODUCT IS COVERED BY ONE OR MORE OF THE FOLLOWING PATENTS:  
 US 9,404,278; US 9,051,748; US 8,671,624; US 8,015,754; US 7,762,025; 7,823,338;  
 CA 2,587,968; CA 2,682,764; EP 1812666; DZ 5173; EG 25627; NG RPNG/C/C2007/737; EP 2137356

THIS DOCUMENT CONTAINS INFORMATION THAT IS CONFIDENTIAL AND PROPRIETARY TO MODULAR SECURITY SYSTEMS, INC. THIS DOCUMENT IS FURNISHED ON THE UNDERSTANDING THAT THE DOCUMENT AND THE INFORMATION IT CONTAINS WILL NOT BE REPRODUCED OR DISCLOSED TO OTHERS WITHOUT THE WRITTEN CONSENT OF MODULAR SECURITY SYSTEMS, INC. OR USED FOR ANY PURPOSE OTHER THAN CONDUCTING BUSINESS WITH MODULAR SECURITY SYSTEMS, INC. AND WILL BE RETURNED AND ALL FURTHER USE DISCONTINUED UPON REQUEST BY MODULAR SECURITY SYSTEMS, INC. COPYRIGHT MODULAR SECURITY SYSTEMS, INC. FIRST YEAR COPYRIGHT IS FIRST YEAR INDICATED ON THIS DOCUMENT. ALL RIGHTS RESERVED.

<b>MSSI</b> Modular Security Systems		PROJECT NO <b>M17-279</b>		CUSTOMER <b>MSSI STANDARDS</b>		PROJECT <b>MAC4T</b>	
TITLE <b>ISOMETRIC SHEETS - OVERALL 1</b>		REVISIONS		SCALE N.T.S.		DWG NO <b>M17-279-M4TX-0100</b>	
NO.	DATE	BY	DESCRIPTION	NO.	DATE	BY	DESCRIPTION
0	11/13/2017	NSM	INITIAL RELEASE	1	3/28/2018	IBH	
A	12/6/2017	JES	MANUFACTURING REVISIONS	2	3/28/2018	KH	
B	3/27/2018	REA	MANUFACTURING REVISIONS	3	3/28/2018	JES	
C	3/29/2018	REA	MANUFACTURING REVIEW	4	10/12/2017	NSM	

COMMENTS:  
 FINISH ALL MACHINED SURFACES AND BREAK ALL SHARP EDGES UNLESS OTHERWISE SPECIFIED.  
 TOLERANCES ON ALL DIMENSIONS UNLESS OTHERWISE NOTED SHALL BE:  
 ONE PLACE DECIMAL ± 0.03  
 THREE PLACE DECIMAL ± 0.005  
 FRACTIONAL ± 1/16"  
 ANGULAR ± 1°

SECURED BY MFC .COM

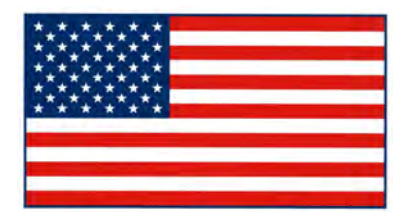
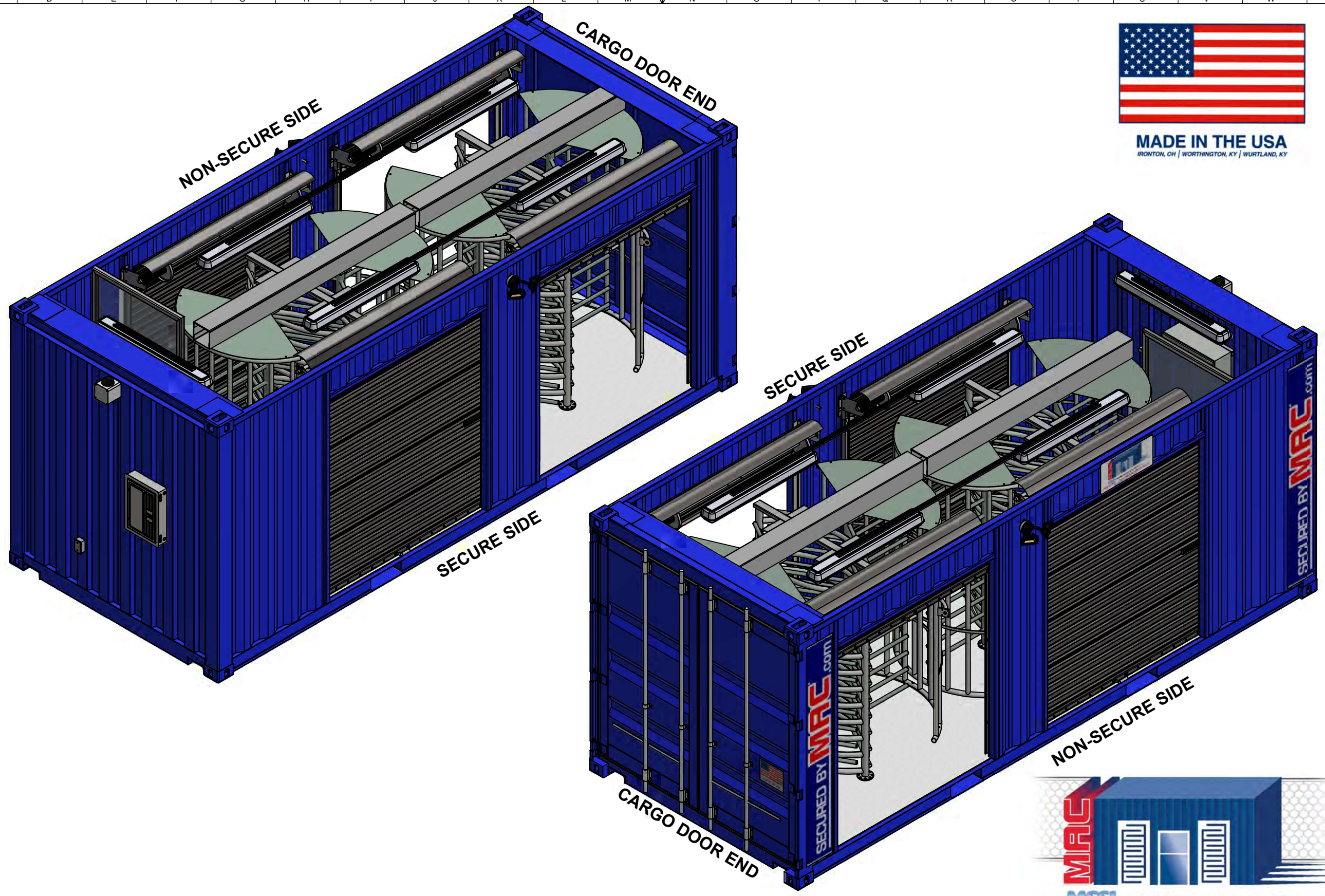

**MADE IN THE USA**  
 IRONTON, OH | WORTHINGTON, KY | WURTLAND, KY

THIRD ANGLE PROJECTION	SHEET SIZE
	ANSI D

**ISOMETRIC SHEETS - OVERALL 2**



THIS MSSI PRODUCT IS COVERED BY ONE OR MORE OF THE FOLLOWING PATENTS:  
 US 9,404,278; US 9,051,748; US 8,671,624; US 8,015,754; US 7,762,025; 7,823,338;  
 CA 2,587,968; CA 2,682,764; EP 1812666; DZ 5173; EG 25627; NG RPNG/C/C2007/737; EP 2137356

THIS DOCUMENT CONTAINS INFORMATION THAT IS CONFIDENTIAL AND PROPRIETARY TO MODULAR SECURITY SYSTEMS, INC. THIS DOCUMENT IS FURNISHED ON THE UNDERSTANDING THAT THE DOCUMENT AND THE INFORMATION IT CONTAINS WILL NOT BE REPRODUCED OR DISCLOSED TO OTHERS WITHOUT THE WRITTEN CONSENT OF MODULAR SECURITY SYSTEMS, INC. OR USED FOR ANY PURPOSE OTHER THAN CONDUCTING BUSINESS WITH MODULAR SECURITY SYSTEMS, INC. AND WILL BE RETURNED AND ALL FURTHER USE DISCONTINUED UPON REQUEST BY MODULAR SECURITY SYSTEMS, INC. COPYRIGHT MODULAR SECURITY SYSTEMS, INC. FIRST YEAR COPYRIGHT IS FIRST YEAR INDICATED ON THIS DOCUMENT. ALL RIGHTS RESERVED.

<table border="1"> <tr> <td>NO.</td> <td>DATE</td> <td>BY</td> <td>DESCRIPTION</td> </tr> <tr> <td>0</td> <td>11/13/2017</td> <td>NSM</td> <td>INITIAL RELEASE</td> </tr> <tr> <td>A</td> <td>12/6/2017</td> <td>JES</td> <td>MANUFACTURING REVISIONS</td> </tr> <tr> <td>B</td> <td>3/27/2018</td> <td>REA</td> <td>MANUFACTURING REVISIONS</td> </tr> <tr> <td>C</td> <td>3/28/2018</td> <td>REA</td> <td>MANUFACTURING REVIEW</td> </tr> </table>		NO.	DATE	BY	DESCRIPTION	0	11/13/2017	NSM	INITIAL RELEASE	A	12/6/2017	JES	MANUFACTURING REVISIONS	B	3/27/2018	REA	MANUFACTURING REVISIONS	C	3/28/2018	REA	MANUFACTURING REVIEW	<table border="1"> <tr> <td>BY</td> <td>DATE</td> </tr> <tr> <td>NSM</td> <td>10/12/2017</td> </tr> <tr> <td>JES</td> <td>3/28/2018</td> </tr> <tr> <td>KH</td> <td>3/28/2018</td> </tr> <tr> <td>IBH</td> <td>3/28/2018</td> </tr> </table>		BY	DATE	NSM	10/12/2017	JES	3/28/2018	KH	3/28/2018	IBH	3/28/2018
NO.	DATE	BY	DESCRIPTION																														
0	11/13/2017	NSM	INITIAL RELEASE																														
A	12/6/2017	JES	MANUFACTURING REVISIONS																														
B	3/27/2018	REA	MANUFACTURING REVISIONS																														
C	3/28/2018	REA	MANUFACTURING REVIEW																														
BY	DATE																																
NSM	10/12/2017																																
JES	3/28/2018																																
KH	3/28/2018																																
IBH	3/28/2018																																
<table border="1"> <tr> <td>SCALE</td> <td>N.T.S.</td> </tr> <tr> <td>DWG NO</td> <td>M17-279-M4TX-0101</td> </tr> </table>		SCALE	N.T.S.	DWG NO	M17-279-M4TX-0101	<table border="1"> <tr> <td>COMMENTS:</td> </tr> <tr> <td>BREAK ALL SHARP EDGES UNLESS OTHERWISE SPECIFIED.</td> </tr> <tr> <td>FINISH ALL MACHINED SURFACES AND BREAK ALL SHARP EDGES UNLESS OTHERWISE SPECIFIED.</td> </tr> <tr> <td>TOLERANCES ON ALL DIMENSIONS UNLESS OTHERWISE NOTED SHALL BE:                  ONE PLACE DECIMAL ± 0.03                  THREE PLACE DECIMAL ± 0.005                  FRACTIONAL ± 1/16"                  ANGULAR ± 1°</td> </tr> </table>		COMMENTS:	BREAK ALL SHARP EDGES UNLESS OTHERWISE SPECIFIED.	FINISH ALL MACHINED SURFACES AND BREAK ALL SHARP EDGES UNLESS OTHERWISE SPECIFIED.	TOLERANCES ON ALL DIMENSIONS UNLESS OTHERWISE NOTED SHALL BE: ONE PLACE DECIMAL ± 0.03 THREE PLACE DECIMAL ± 0.005 FRACTIONAL ± 1/16" ANGULAR ± 1°																						
SCALE	N.T.S.																																
DWG NO	M17-279-M4TX-0101																																
COMMENTS:																																	
BREAK ALL SHARP EDGES UNLESS OTHERWISE SPECIFIED.																																	
FINISH ALL MACHINED SURFACES AND BREAK ALL SHARP EDGES UNLESS OTHERWISE SPECIFIED.																																	
TOLERANCES ON ALL DIMENSIONS UNLESS OTHERWISE NOTED SHALL BE: ONE PLACE DECIMAL ± 0.03 THREE PLACE DECIMAL ± 0.005 FRACTIONAL ± 1/16" ANGULAR ± 1°																																	
<table border="1"> <tr> <td>TITLE</td> <td>ISOMETRIC SHEETS - OVERALL 2</td> </tr> </table>		TITLE	ISOMETRIC SHEETS - OVERALL 2	<table border="1"> <tr> <td>CUSTOMER</td> <td>MSSI STANDARDS</td> </tr> <tr> <td>PROJECT NO</td> <td>M17-279</td> </tr> <tr> <td>PROJECT</td> <td>MAC4T</td> </tr> </table>		CUSTOMER	MSSI STANDARDS	PROJECT NO	M17-279	PROJECT	MAC4T																						
TITLE	ISOMETRIC SHEETS - OVERALL 2																																
CUSTOMER	MSSI STANDARDS																																
PROJECT NO	M17-279																																
PROJECT	MAC4T																																

FINISH SCHEDULE		NOTES	
SPACE	MATERIALS	WALLS	CEILING
TURNSTILE BAY	FRAMING	N/A	N/A
	INSULATION	N/A	N/A
	SUBSURFACE	N/A	N/A
	SURFACE	PAINTED STEEL	PAINTED STEEL
			EXISTING CONTAINER PURLINS
			N/A
			EXISTING 1-1/8" PLYWOOD
			N/A
			SPRAY-ON SKID-RESISTANT
			N/A

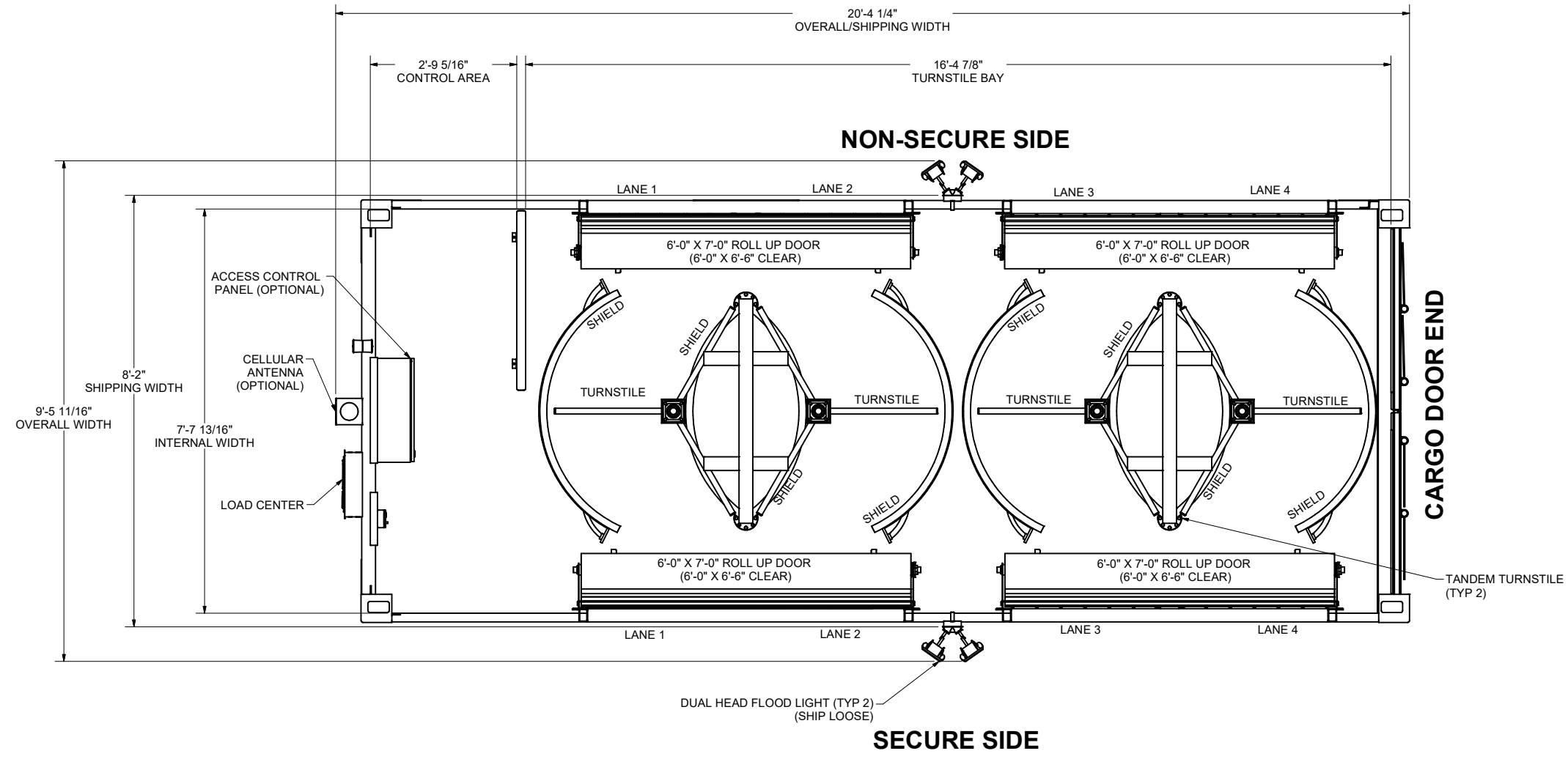

**GENERAL ARRANGEMENT - PLAN VIEW**  
SCALE 3/4" = 1'-0"

NO.	DATE	DESCRIPTION	BY
4	10/12/2017	MANUFACTURING REVIEW	NSM
3	3/28/2018	MANUFACTURING REVISIONS	JES
2	3/28/2018	MANUFACTURING REVISIONS	JES
1	3/28/2018	INITIAL RELEASE	KH
	3/28/2018		IBH

COMMENTS:  
FINISH ALL MACHINED SURFACES AND BREAK ALL SHARP EDGES UNLESS OTHERWISE SPECIFIED.  
THE NUMBER IN THE FINISH SYMBOL IS THE MAXIMUM ACCEPTABLE ROUNDNESS VALUE IN A. MICROINCHES.

SCALE 3/4" = 1'-0"  
DWG NO M17-279-M4TX-0200

NO.	DATE	DESCRIPTION	BY
C	3/28/2018	RE MANUFACTURING REVIEW	NSM
B	3/27/2018	RE MANUFACTURING REVISIONS	JES
A	12/6/2017	JES MANUFACTURING REVISIONS	JES
0	11/13/2017	NSM INITIAL RELEASE	NSM

TITLE GENERAL ARRANGEMENT - PLAN VIEW

**MSSI**  
Modular Security Systems

CUSTOMER MSSI STANDARDS

PROJECT NO M17-279

PROJECT MAC4T

THIS MSSI PRODUCT IS COVERED BY ONE OR MORE OF THE FOLLOWING PATENTS:  
US 9,404,278; US 9,051,748; US 8,671,624; US 8,015,754; US 7,762,025; 7,823,338;  
CA 2,587,968; CA 2,682,764; EP 1812666; DZ 5173; EG 25627; NG RPNG/C/C2007/737; EP 2137356

THIS DOCUMENT CONTAINS INFORMATION THAT IS CONFIDENTIAL AND PROPRIETARY TO MODULAR SECURITY SYSTEMS, INC. THIS DOCUMENT IS FURNISHED ON THE UNDERSTANDING THAT THE DOCUMENT AND THE INFORMATION IT CONTAINS WILL NOT BE REPRODUCED OR DISCLOSED TO OTHERS WITHOUT THE WRITTEN CONSENT OF MODULAR SECURITY SYSTEMS, INC. OR USED FOR ANY PURPOSE OTHER THAN CONDUCTING BUSINESS WITH MODULAR SECURITY SYSTEMS, INC. AND WILL BE RETURNED AND ALL FURTHER USE DISCONTINUED UPON REQUEST BY MODULAR SECURITY SYSTEMS, INC. COPYRIGHT MODULAR SECURITY SYSTEMS, INC. FIRST YEAR COPYRIGHT IS FIRST YEAR INDICATED ON THIS DOCUMENT. ALL RIGHTS RESERVED.

THIRD ANGLE PROJECTION	SHEET SIZE
	ANSI D