



PC-1000C4 Antenna Coupler

Part Number: SLF20050/C4

SPECIFICATION SHEET

5055 Belmont, Beaumont, TX 77707
 Phone +409.842.1717 Fax +409.842.2987
 sales@southernavionics.com



PC-1000C4 Antenna Coupler

Application:

The PC-1000C4 Antenna tuning unit is designed to match 200-1500pF/2-30 Ohms antenna load in the 190-625 kHz frequency range, RF input power is 500 Watts peak.

The coupler has an auto-tune feature which automatically maintains system match and tuning during changing environmental conditions and antenna characteristics. A variable coil ensures resonance is maintained while a resistive matching network ensures the transmitter always sees a 50 Ohm load thus minimizing VSWR.

The PC-1000C4 ATU comes standard with an IP66 Breather drain.

The unit is housed in an IP66-Certified aluminum enclosure with latches for all weather operation. Operating power is supplied by SAC transmitter or optional 100-264VAC internal power supply.

*Information provided is subject to change without notice

FEATURE	SPECIFICATION
Input Impedance	50 Ohms
Load Impedance	2-30 Ohms resistance 200-1500pF capacitance
Frequency	190-625khz with a 200-1500pF load
Power Input	Up to 500W, 200W continuous
Tuning	Tuning is achieved with a large coil with coarse taps and fine taps and a rotatable shorted ring. The coarse taps are selected by jumper while the fine taps are selected by a jumper and wires across a terminal block behind a removable panel. The auto-tune system drives the shorted ring for exact tuning
Tuning Range	22 uH to 3.6 mH
Metering	Antenna current, Forward and Reflected Watts and tune measurements displayed on a single meter via a twelve position switch
Lightning Protection	A lightning gap at the antenna terminal and a special passive circuit each protect the transmitter's final amplifiers from lightning transients
Access	Removable front access door via stainless steel/quick release latches
Operating Conditions	-50°C-+70°C; relative humidity 0-100%; high salinity for offshore; IP66 certified
Height	21in / 54cm
Length	17in / 43cm
Width	21in / 54cm
Weight	42lbs / 19kg
Power Requirements	DC control voltage (SAC transmitter)
Optional Equipment	100-264VAC Internal Power Supply, 100 Watt Heater, Solar Shield, Antenna Analyzer, Antenna Simulator
Connection	Type-N female



NDB Transmitter

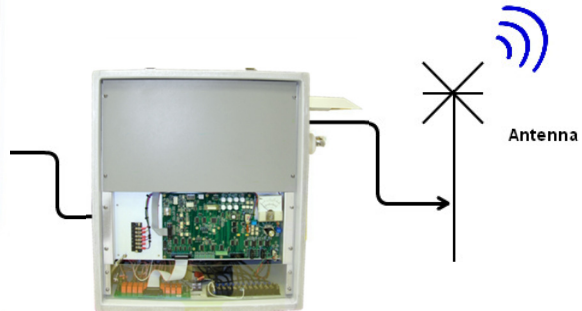

ATU



IP-66 Enclosure with removable Door



IP-66 Enclosure with Door Removed and Panels in Place